

# Shaft Collars

General Information

Shaft collars can be used in multiple ways in machine and fixture construction: They secure shafts and axles, act as an end stop or as an attachment option for additional functional elements. A classification of shaft collars can be done based on the type of clamping and the assembly options.

## Set screw shaft collars

GN 705 set screw shaft collars have the simplest structure with their solid circular body and they comply with DIN 705. Clamping is done radially with a set screw that presses onto the surface of the shaft or axle.

This type of shaft collar can be used optimally with a drilling or a groove at the shaft or axle, which ensures exact repositioning of the shaft collar and prevents damage to the clamping point of the shaft or axle surface.



## Semi-split shaft collars

GN 706.2 semi-split shaft collars are assembled axially on shafts or axles. The clamping creates a non-positive connection of the entire inside surface of the shaft collar with the shaft or the axle. Extremely high clamping and retaining forces are achieved by reducing the slot height via a socket cap screw.



## Split shaft collars

GN 707.2 split shaft collars can be set axially as well as radially on the shaft or axle and are then held together by two socket cap screws. Clamping is similarly done as in the semi-split version, by reducing the slot height using a socket cap screw.

GN 707.2 split shaft collars correspond dimensionally to the GN 706.2 semi-split version so that they can be exchanged with each other, depending on the application.



## Shaft collars with additional function

Expanding on the two previously mentioned types of shaft collars, versions with „additional features“ are also available. Additional radial or axially parallel holes, with or without thread, easily facilitate attaching rings, for instance as a flange or to attach other components such as sensor brackets on the shaft collar. Versions with an adjustable lever or a damping washer complete the program.

Adjustable levers, damping washers and matching sensor brackets are also available individually as accessories or for retrofitting via a separate Winco standard for all series of the GN 706 and GN 707 shaft collar range.



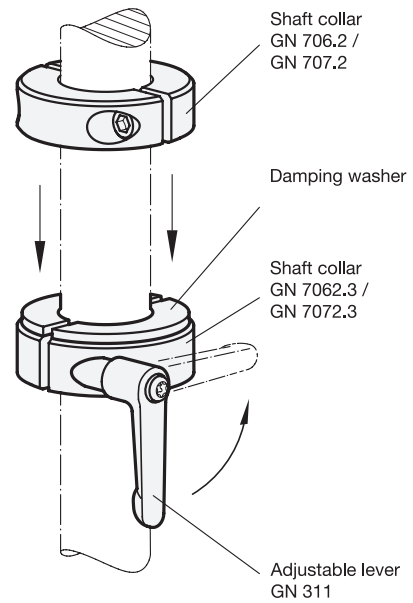
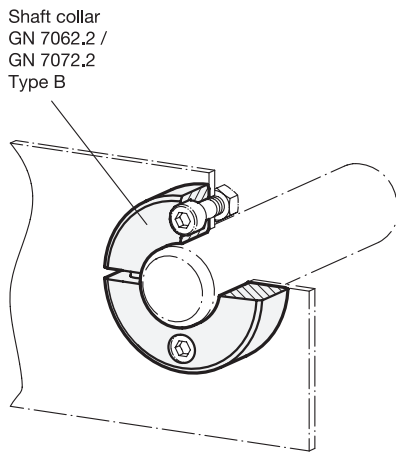
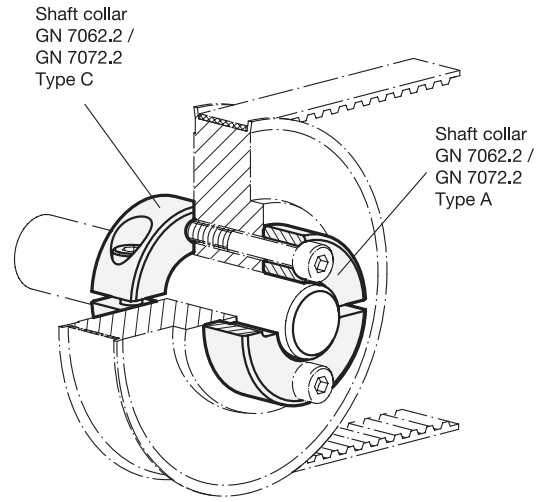
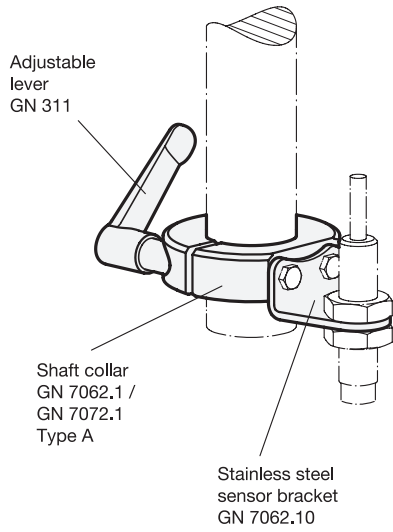

3.1

3.2

3.3

3.4

3.5

3.6

3.7

3.8

3.9

3.10

