

Transfer Units and Angular Gears

Application Example

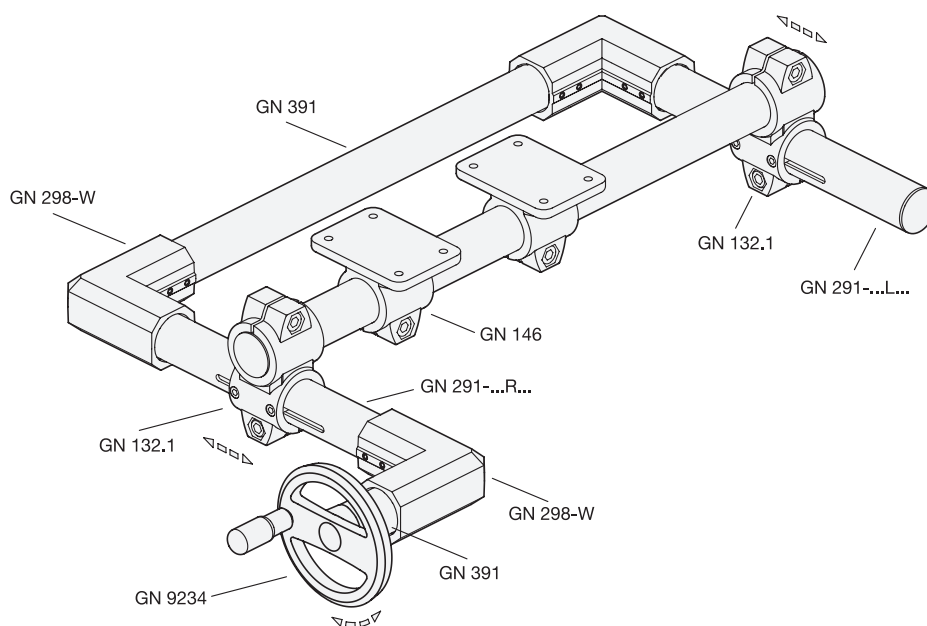

Two parallel sliding GN 291 linear actuators are connected via a GN 391 transfer unit.

The handwheel is connected to the system via the GN 298-W angular housings including the GN 297 bevel-gear wheels and another GN 391 transfer unit. The handwheel is placed in a rectangular position to the movement axes.

Transfer Units and Angular Gears

Application Example

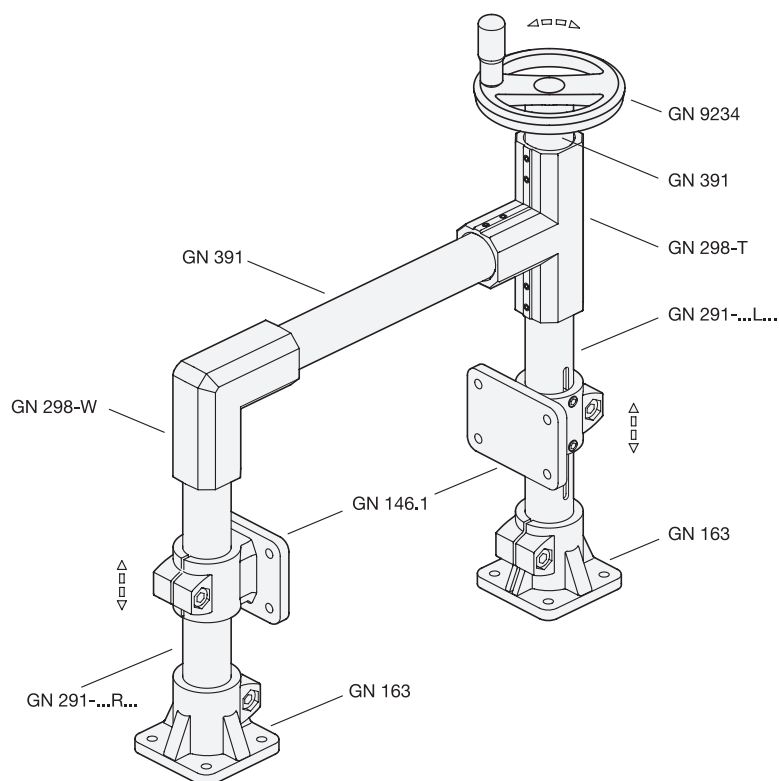

Two GN 146.1 flanged linear actuator connectors are moved parallel. For this, two GN 291 linear actuators are connected via a GN 391 transfer unit.

The handwheel is connected to the system via the GN 298-T / -W angular and T-gear including the GN 297 bevel-gear wheels and another GN 391 transfer unit. The handwheel is placed in a parallel position to the movement axes.

3.1
3.2
3.3
3.4
3.5
3.6
3.7
3.8
3.9
3.10