

Inch

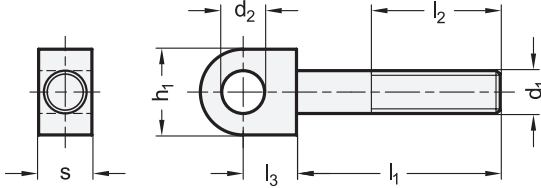

Inch table

Dimensions in: inches / millimeters

1 d_1	2 l_1	3 d_2 <small>+0.001 +0.003 Slip fit</small>	l_2	l_3	h_1	s
1/4 x 20	1.19 30.2	1/4	0.75 19.1	0.31 7.9	0.50 12.7	0.31 7.9
1/4 x 20	2.19 55.6	1/4	1.25 31.8	0.31 7.9	0.50 12.7	0.31 7.9
5/16 x 18	1.63 41.4	5/16	1.00 25.4	0.38 9.7	0.63 16	0.38 9.7
5/16 x 18	2.63 66.8	5/16	1.38 35.1	0.38 9.7	0.63 16	0.38 9.7
3/8 x 16	2.00 50.8	3/8	1.38 35.1	0.50 12.7	0.75 19.1	0.50 12.7
3/8 x 16	3.00 76.2	3/8	2.00 50.8	0.50 12.7	0.75 19.1	0.50 12.7
1/2 x 13	2.50 63.5	1/2	1.75 44.5	0.63 16	1.00 25.4	0.63 16
1/2 x 13	3.50 88.9	1/2	2.25 57.2	0.63 16	1.00 25.4	0.63 16
5/8 x 11	2.75 69.9	5/8	1.63 41.4	0.75 19.1	1.25 31.8	0.75 19.1
5/8 x 11	4.00 101.6	5/8	2.50 63.5	0.75 19.1	1.25 31.8	0.75 19.1

Specification

Steel

- Cold finished low carbon
- Case-hardened
- Blackened finish

RoHS

Latch bolts LB have many applications in the construction of machinery, jigs, fixtures, and other tooling.

see also...

	Page
DIN 444 Swing Bolts (Metric Size)	QVX
GN 1524 Swing Bolts (Metric Size, with Extended Thread Length)	QVX
SEB Swing Bolts (Inch Size)	QVX

How to order

LB-5/16X18-1.63-5/16

- 1** Thread d_1
- 2** Length l_1
- 3** Slip fit d_2

3.1
3.2
3.3
3.4
3.5
3.6
3.7
3.8
3.9
3.10