

Inch

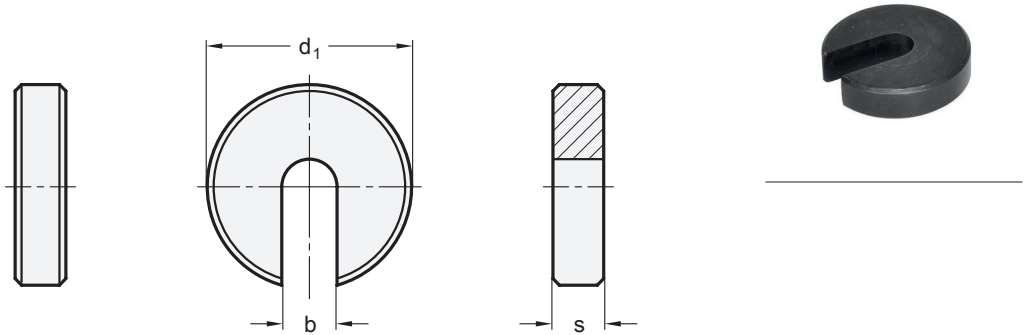

Inch table

1 For thread size	2 d <sub>1</sub>	b	s
1/4	1.25 31.8	0.28 7.1	0.25 6.4
5/16	1.25 31.8	0.34 8.6	0.31 7.9
3/8	1.50 38.1	0.41 10.4	0.38 9.7
1/2	2.00 50.8	0.53 13.5	0.38 9.7
5/8	2.13 54.1	0.63 16	0.38 9.7
3/4	2.50 63.5	0.78 19.8	0.44 11.2
7/8	2.63 66.8	0.91 23.1	0.50 12.7
1.00	3.00 76.2	1.03 26.2	0.56 14.2

Dimensions in: inches / millimeters

Specification

Steel

- Case-hardened
- Black oxide finish
- All sharp edges removed
- Surface flat and parallel

RoHS



ST

Heavy duty C-washers HDCW are designed to be slid in and out of position on a bolt or shaft in a partially completed assembly or fixture. They can also be used as a retention device to keep components in place.

see also...

	Page
GN 183 Knurled C-Washers (Metric Size)	QVX
SCW Swing C-Washers	QVX

How to order

HDCW-1/4-1.25-ST

1	For thread size
2	Outer diameter d <sub>1</sub>
3	Material

3.1  
3.2  
3.3  
3.4  
3.5  
3.6  
3.7  
3.8  
3.9  
3.10

