

Assembly instruction

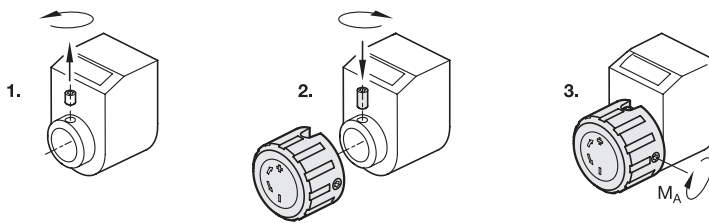

2 Type

- N Without lettering
- R With lettering, with arrow, ascending clockwise
- L With lettering, with arrow, ascending counter-clockwise

Metric table

Dimensions in: millimeters - inches						
d ₁ Hollow shaft diameter of digital position indicator	d ₂	d ₃	d ₄	h	Recommended torque M _A in Nm	For digital position indicator
14 0.55	14.5 0.57	23.5 0.93	M 3	15 0.59	0.2	EN 955 / EN 955.2
20 0.79	20.5 0.81	32 1.26	M 4	20 0.79	0.2	EN 954 / EN 954.2 / EN 9054 / EN 9154
29 1.14	29.5 1.16	41 1.61	M 4	25 0.98	0.2	EN 953 / EN 953.2 / EN 9053 / EN 9153

Specification

- Body
Plastic
Technopolymer (Polyamide PA)
- Black, matte finish
- Temperature resistant up to 176 °F (80 °C)
- Cover cap
Plastic
Technopolymer (Polypropylen PP)
- Orange, RAL 2004, matte finish ● DOR
- Gray, RAL 7035, matte finish ● DGR
- Set screws DIN 916
Stainless steel
With internal hex and serrated point
- Plastic Characteristics → page QVX
- RoHS

Information

Control knobs EN 957.1 are used in conjunction with digital position indicators when a control knob is to be used for adjustment. The diameter d₂ is coordinated to the hollow shaft diameter of the relevant position indicator.

The set screw of the digital position indicator must be replaced by a longer set screw enclosed with the control knob in order to clamp the adjusting shaft.

The control knob is then placed on the hollow shaft of the digital position indicator, with the newly inserted set screw in the recess of the control knob serving as a swivel limiting stop.

With the aid of the second set screw d₄, the control knob then is axially fixed on the hollow shaft of digital the position indicator with the recommended torque M_A.

see also...

- Digital Position Indicators EN 953 / EN 954 / EN 955 → page QVX / XYZ / XYZ
- Digital Position Indicators EN 953.2 / EN 954.2 / EN 955.2 → page QVX / XYZ / XYZ
- Digital Position Indicators EN 9053 / EN 9054 → page QVX / QVX
- Digital Position Indicators EN 9153 / EN 9154 → page QVX / QVX

How to order EN957.1-20-N-DOR	1	Hollow shaft diameter d ₁
	2	Type
	3	Color of the cover cap