

Installation instructions

Before installation of the position indicator a bore for the torque limiting contact point is to be placed (see left).

With the **EN 952.1 mounting adapters** the hollow shaft (with bore 20 H7) of the position indicator can be adapted to fit the spindle. → page 388

The mounting of the position indicator is via the torque limiting contact point which is connected to the hollow spindle and secured with a set screw.

Before completing the installation, turn the spindle to the starting point (0 position) and zero the position indicator.

With **GN 954.7 clamping plates** spindles can be clamped and secured after adjusting. → page XYZ

EN 954.1 | Spacer Plate

Technopolymer Plastic, for Digital Position Indicators EN 954 / EN 954.2

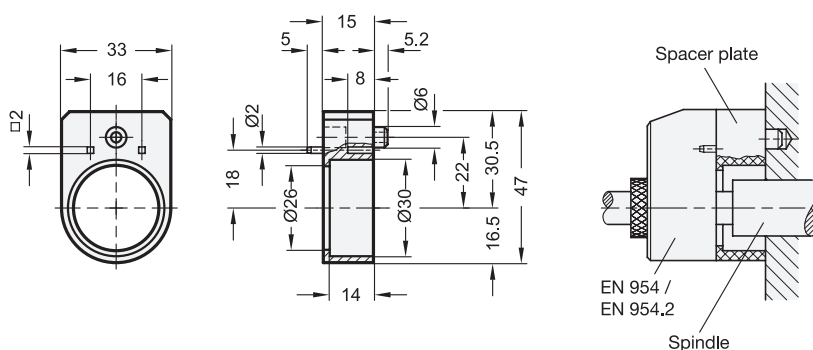

Specification

- Plastic
Technopolymer (Polyamide PA)
Black, matte finish
- RoHS compliant

Information

The spacer plate EN 954.1 in combination with the digital position indicators EN 954 / EN 954.2 are used to bridge the shaft shoulders, set collars and so on.

The square bore holes are used for the machine-side fastening with e.g. socket button head self-tapping screws in accordance with DIN ISO 7049.

see also...

- Digital Position Indicators EN 954 (Steel Shaft Receptacle) → page XYZ
- Digital Position Indicators EN 954.2 (Stainless Steel Shaft Receptacle) → page XYZ

How to order

EN 954.1