

**Inch table**

Dimensions in: inches - millimeters

l <sub>1</sub>	d <sub>1</sub> Thread	d <sub>2</sub> Thread	l <sub>2</sub> In clamping position								b	d <sub>3</sub>	d <sub>4</sub>	d <sub>5</sub>	h Stroke at 90° lever movement	l <sub>3</sub> In clamping position	l <sub>4</sub> Adjustable range	l <sub>5</sub> In clamping position	t Usable thread length
			0.63 16	0.79 20	0.98 25	1.18 30	1.38 35	1.57 40	1.97 50	0.63 16									
2.48 63	10 x 32	10 x 32	0.63 16	0.79 20	0.98 25	1.18 30	1.38 35	1.57 40	1.97 50	0.63 16	0.63 16	0.75 19	0.73 18.5	0.03 0.75	0.64 16.3	0.10 2.5	0.12 3	0.39 10	
2.48 63	1/4 x 20	1/4 x 20	0.63 16	0.79 20	0.98 25	1.18 30	1.38 35	1.57 40	1.97 50	0.63 16	0.63 16	0.75 19	0.73 18.5	0.03 0.75	0.64 16.3	0.10 2.5	0.12 3	0.39 10	
3.23 82	1/4 x 20	1/4 x 20	0.79 20	0.98 25	1.18 30	1.38 35	1.57 40	1.97 50	2.36 60	0.79 20	0.79 20	0.98 25	0.89 22.5	0.04 1	0.77 19.5	0.12 3	0.15 3.7	0.47 12	
3.23 82	5/16 x 18	5/16 x 18	0.79 20	0.98 25	1.18 30	1.38 35	1.57 40	1.97 50	2.36 60	0.79 20	0.79 20	0.98 25	0.89 22.5	0.04 1	0.77 19.5	0.12 3	0.15 3.7	0.47 12	
3.98 101	5/16 x 18	5/16 x 18	0.79 20	0.98 25	1.18 30	1.38 35	1.57 40	1.97 50	2.36 60	0.98 25	1.02 26	1.18 30	1.06 27	0.06 1.5	1.00 25.3	0.16 4	0.19 4.8	0.59 15	
3.98 101	3/8 x 16	3/8 x 16	0.79 20	0.98 25	1.18 30	1.38 35	1.57 40	1.97 50	2.36 60	0.98 25	1.02 26	1.18 30	1.06 27	0.06 1.5	1.00 25.3	0.16 4	0.19 4.8	0.59 15	

**Metric table**

Dimensions in: millimeters - inches

l <sub>1</sub>	d <sub>1</sub> Thread	d <sub>2</sub> Thread	l <sub>2</sub> In clamping position								b	d <sub>3</sub>	d <sub>4</sub>	d <sub>5</sub>	h Stroke at 90° lever movement	l <sub>3</sub> In clamping position	l <sub>4</sub> Adjustable range	l <sub>5</sub> In clamping position	t Usable thread length
			12 0.47	16 0.63	20 0.79	25 0.98	30 1.18	35 1.38	40 1.57	40 1.57									
44 1.73	M 4	M 4	12 0.47	16 0.63	20 0.79	25 0.98	30 1.18	-	-	12 0.47	12 0.47	15 0.59	14 0.55	0.5 0.02	13.2 0.52	2 0.08	2.2 0.09	8 0.31	
44 1.73	M 5	M 5	12 0.47	16 0.63	20 0.79	25 0.98	30 1.18	35 1.38	40 1.57	12 0.47	12 0.47	15 0.59	14 0.55	0.5 0.02	13.2 0.52	2 0.08	2.2 0.09	8 0.31	
63 2.48	M 5	M 5	16 0.63	20 0.79	25 0.98	30 1.18	35 1.38	40 1.57	50 1.97	16 0.63	16 0.63	19 0.75	18.5 0.73	0.75 0.03	16.3 0.64	2.5 0.10	3 0.12	0.39 10	
63 2.48	M 6	M 6	16 0.63	20 0.79	25 0.98	30 1.18	35 1.38	40 1.57	50 1.97	16 0.63	16 0.63	19 0.75	18.5 0.73	0.75 0.03	16.3 0.64	2.5 0.10	3 0.12	0.39 10	
82 3.23	M 6	M 6	20 0.79	25 0.98	30 1.18	35 1.38	40 1.57	50 1.97	60 2.36	20 0.79	20 0.79	25 0.98	22.5 0.89	1 0.04	19.5 0.77	3 0.12	3.7 0.15	0.47 12	
82 3.23	M 8	M 8	20 0.79	25 0.98	30 1.18	35 1.38	40 1.57	50 1.97	60 2.36	20 0.79	20 0.79	25 0.98	22.5 0.89	1 0.04	19.5 0.77	3 0.12	3.7 0.15	0.47 12	
101 3.98	M 8	M 8	20 0.79	25 0.98	30 1.18	35 1.38	40 1.57	50 1.97	60 2.36	25 0.98	26 1.02	30 1.18	27 1.06	1.5 0.06	25.3 1.00	4 0.16	4.8 0.19	0.59 15	
101 3.98	M 10	M 10	20 0.79	25 0.98	30 1.18	35 1.38	40 1.57	50 1.97	60 2.36	25 0.98	26 1.02	30 1.18	27 1.06	1.5 0.06	25.3 1.00	4 0.16	4.8 0.19	0.59 15	

**Constructional features (Type A)**

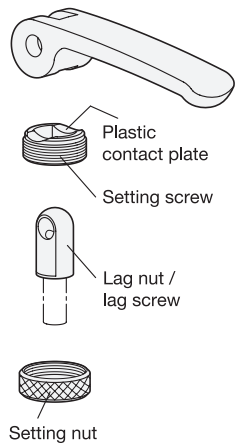

l<sub>4</sub> adjustable by the setting screw for optimum clamping force at the preferred lever position.

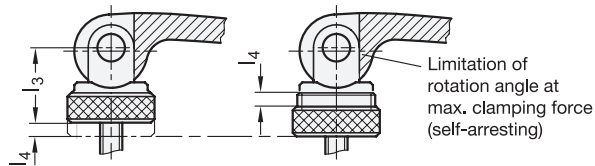

l<sub>4</sub> must not be exceeded. Otherwise there is the risk that the positioning thread can no longer absorb the clamping force or may be damaged.