

Disk handwheel

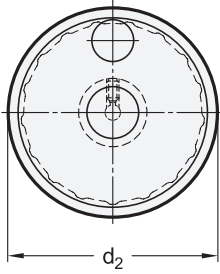

Spoked handwheel

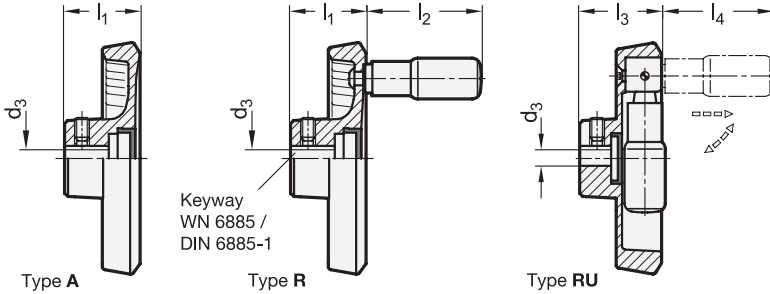
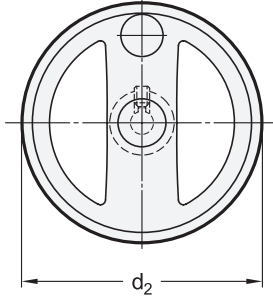

Assembly examples

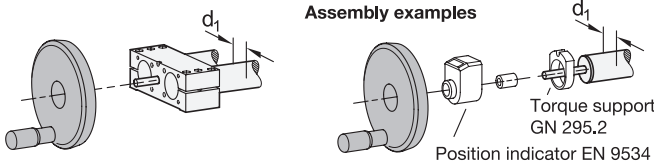

Metric



- 3 Type**
- A** Without handle
 - R** With revolving handle
 - RU** With revolving retractable handle

Specification

Body

- Aluminum die-cast
- Contact face of hub machined
- Rim turned
- Radial and axial runout of the rim < 0.4 mm
- Powder coated
- Black, RAL 9005, textured finish ● **SW**

Cover

- Plastic, Polyamide (PA)
- Light gray

Stepped cylindrical revolving handle GN 798.2

- Plastic, Polyamide (PA)
- Black, matte finish
- Spindle
- Steel, zinc plated, blue passivated finish

Stepped retractable handle GN 798.3

- Plastic, Polyamide (PA)
- Black, matte finish
- Retractable mechanism
- Steel, blackened finish

Mini cylindrical revolving handle GN 599.5

- Plastic, Polyamide (PA)
- Black, matte finish
- Spindle
- Stainless steel AISI 303

RoHS

Handwheels GN 9234 are intended for use with linear actuators and are designed as disk or spoked handwheels, depending on their size. The applied torque is transmitted by means of a parallel key, and the handwheel is secured axially with the supplied set screw. The handwheels can be ordered without handles, with revolving handles or with revolving retractable handles.

see also...	Page
GN 291 Linear Actuators	QVX
GN 292 Linear Actuators	QVX
GN 293 Linear Actuators	QVX
GN 491 Double Tube Linear Actuators	QVX
GN 492 Double Tube Linear Actuators	QVX

Technical Information

Keyways WN 6885 / DIN 6885-1	QVX
Cross Holes GN 110	QVX
ISO Fundamental Tolerances	QVX

How to order

GN 9234-30-100-R-SW

1	Diameter d_1
2	Diameter d_2
3	Type
4	Finish

3.1
3.2
3.3
3.4
3.5
3.6
3.7
3.8
3.9
3.10

Metric table

Dimensions in: millimeters / inches

d₁ Ø Linear actuator	d₂ Disk handwheel Spoked handwheel	d₃ H7 Bore	l₁ ≈	l₂ ≈	l₃ ≈	l₄ ≈	Ø Handle GN 599.5	Ø Handle GN 798.2	Ø Handle GN 798.3	
18* 0.71	50 1.97	-	6 0.236	26 1.02	20 0.79	-	-	13 0.51	-	-
18* 0.71	80 3.15	-	6 0.236	26 1.02	43.5 1.71	-	-	-	16 0.63	-
25* 0.98	63 2.48	-	8 0.315	27 1.06	20 0.79	-	-	13 0.51	-	-
25 0.98	100 3.94	-	8 0.315	30 1.18	58 2.28	39 1.54	56.5 2.22	-	18 0.71	18 0.71
30* 1.18	63 2.48	-	8 0.315	27 1.06	20 0.79	-	-	13 0.51	-	-
30 1.18	100 3.94	-	8 0.315	30 1.18	58 2.28	39 1.54	56.5 2.22	-	18 0.71	18 0.71
40 1.57	100 3.94	-	12 0.472	30 1.18	58 2.28	39 1.54	56.5 2.22	-	18 0.71	18 0.71
40 1.57	-	125 4.92	12 0.472	33.5 1.32	61.5 2.42	45 1.77	60.5 2.38	-	22 0.87	22 0.87
50 1.97	-	140 5.51	12 0.472	36.5 1.44	76.5 3.01	47 1.85	75.5 2.97	-	24 0.94	24 0.94
60 2.36	-	160 6.30	14 0.551	39.5 1.56	76.5 3.01	48 1.89	75.5 2.97	-	24 0.94	24 0.94

* Only available in type A and R