

Type T

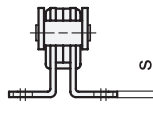

Type TF

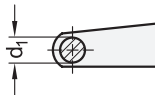
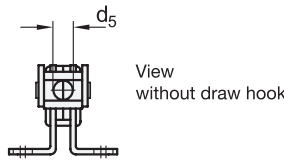
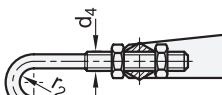

Operating principle

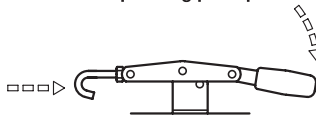

**Metric**



**SS** Stainless Steel

**2 Type**

- T** With draw axle
- TF** With draw hook

**Specification**

**Tensioning mechanism**

- Steel **ST**
  - Sheet metal parts
  - Case-hardened steel C10, zinc plated, blue passivated finish
  - Bearing pins tempered
  - Bearing rivets case hardened
- Stainless steel AISI 304 **NI**
  - Moving parts lubricated with special grease

**Draw hook**

- Steel St 37 for ST
- Zinc plated, blue passivated finish
- Stainless steel AISI 301 for NI

**Handle**

- Plastic
- Red, oil resistant

RoHS

**On request**

- without draw hook (Type TFN)

Latch type toggle clamps GN 850 are suited for rapid closing and fastening of lids, covers and molds.

During clamping, the pivoting motion of the clamping lever is transformed into an axial movement of the draw axle or draw hook and ensures a form-fit hold.

Latch type toggle clamps of type T are equipped with a draw axle firmly attached to the clamping arm. Type TF has a draw hook that can be adjusted within the adjustable range  $w_2$ . The draw hook is supplied unmounted.

see also...

	Page
<b>GN 850.1</b> Latch Type Toggle Clamps	QVX
<b>GN 851</b> Horizontal Latch Type Toggle Clamps	QVX

**Technical Information**

Operating Principle Toggle Lever / Overview Toggle Clamp Types	QVX
Stainless Steel Characteristics	QVX

How to order

**GN 850-220-TF-ST**

<b>1</b>	Size
<b>2</b>	Type
<b>3</b>	Material

## Metric table

Dimensions in: millimeters / inches

Size	F <sub>H</sub> Holding capacity	a <sub>1</sub>	a <sub>2</sub>	b <sub>1</sub>	b <sub>2</sub>	b <sub>3</sub>	d <sub>1</sub>	d <sub>2</sub>	d <sub>3</sub>	d <sub>4</sub>	d <sub>5</sub>	h <sub>1</sub> ≈
160	1400 N 315 lbf	30 1.18	25 0.98	35 1.38	42 1.65	14 0.55	8 0.31	5.5 0.22	5.2 0.20	M 6	6.3 0.25	40 1.57
220	2400 N 540 lbf	37 1.46	29 1.14	41 1.61	45 1.77	18 0.71	10 0.39	6.5 0.26	7.1 0.28	M 8	8.3 0.33	49 1.93
320	3600 N 809 lbf	35 1.38	25 0.98	48 1.89	60 2.36	21 0.83	10 0.39	8.5 0.33	8.8 0.35	M 10	10.3 0.41	49 1.93
420	4800 N 1079 lbf	44 1.73	34 1.34	54 2.13	84 3.31	26 1.02	14 0.55	10.5 0.41	8.8 0.35	M 10	10.3 0.41	60.5 2.38

Size	h <sub>2</sub>	l <sub>1</sub> ≈	l <sub>2</sub> ≈	l <sub>3</sub> ≈	m <sub>1</sub>	m <sub>2</sub>	m <sub>3</sub>	r <sub>1</sub> ≈	r <sub>2</sub>	s	W <sub>1</sub> Stroke	W <sub>2</sub> ≈ Adjustable range
160	13 0.51	176 6.93	44 1.73	81 3.19	16 0.63	27.5 1.08	28.5 1.12	85 3.35	3.2 0.13	2.5 0.10	87 3.43	20 0.79
220	16 0.63	200 7.87	51 2.01	95 3.74	19 0.75	31.5 1.24	32.5 1.28	99 3.90	5 0.20	3 0.12	97 3.82	21 0.83
320	20 0.79	225 8.86	51 2.01	97 3.82	32 1.26	44.5 1.75	45.5 1.79	105 4.13	6 0.24	3 0.12	100 3.94	23.5 0.93
420	25 0.98	275 10.83	58 2.28	107.5 4.23	28.5 1.12	59.7 2.35	61.3 2.41	138 5.43	6 0.24	5 0.20	155 6.10	19.5 0.77

