

**Specification**

- Steel 3
  - Base  
Manganese phosphated
  - Parts in sheet metal  
Case-hardened steel C10  
Zinc plated, blue passivated finish
  - Plunger  
Steel St 37  
Zinc plated, blue passivated finish
  - Bearing pins (rivets)  
Case-hardened  
Zinc plated, blue passivated finish
- Stainless steel NI
  - Body AISI 304
  - Parts in sheet metal AISI 304
  - Plunger AISI 303
  - Bearing pins (rivets) AISI 304
- All moving parts  
Lubricated with special grease
- Hand grip  
High quality, oil resistant red plastic
- *Stainless Steel Characteristics* → page XYZ
- **RoHS compliant**

**Information**

Push-pull type toggle clamps GN 842 can be used for very high holding forces thanks to their very large and sturdy body. In these devices the circular movement of the handle is transformed into a straight-line action of the clamp along its axis.

On the size 70 the mounting holes are countersunk to accept DIN 912-M4 socket cap screws with internal hex.

**see also...**

- *General Information on Toggle Clamps* → page XYZ

**Accessory**

- Spindle assemblies → starting from page 856

How to order (Steel) <span style="color: red;">1</span> <span style="color: red;">2</span> <b>GN 842-1100-AS</b>	1	Size
	2	Type
How to order (Stainless steel) <span style="color: red;">1</span> <span style="color: red;">2</span> <span style="color: red;">3</span> <b>GN 842-360-AS-NI</b>	1	Size
	2	Type
	3	Material

**Metric table**



Dimensions in: millimeters - inches

Size	Steel	Stainless steel	F <sub>H</sub> Holding capacity	a	b <sub>1</sub>	b <sub>2</sub>	d <sub>1</sub>	d <sub>2</sub>	d <sub>3</sub>	h <sub>1</sub> ≈	h <sub>2</sub> ≈	l <sub>1</sub>
70	70	70	1200 N 270 lbf	12 0.47	64 2.52	36 1.42	8.5 0.33	M 6	4.3 0.17	42.5 1.67	19.5 0.77	86 3.39
160	160	160	2800 N 629 lbf	15 0.59	85 3.35	46 1.81	11 0.43	M 6	5.3 0.21	59 2.32	25 0.98	116 4.57
360	360	360	5600 N 1259 lbf	25 0.98	90 3.54	45.5 1.79	12 0.47	M 8	5.5 0.22	75 2.95	34.5 1.36	122 4.80
550	-	-	8000 N 1798 lbf	18 0.71	122.5 4.82	55 2.17	14 0.55	M 8	7 0.28	82.5 3.25	29.5 1.16	164.5 6.48
1100	-	-	16000 N 3597 lbf	25 0.98	133 5.24	57 2.24	16 0.63	M 10	8.5 0.33	95 3.74	38 1.50	182 7.17
2100	-	-	25000 N 5620 lbf	35 1.38	177 6.97	70 2.76	20 0.79	M 12	8.5 0.33	118.5 4.67	50 1.97	238 9.37
3100	-	-	45000 N 10116 lbf	40 1.57	216 8.50	76 2.99	22 0.87	M 14	11 0.43	137 5.39	56 2.20	316 12.44

Size	Steel	Stainless steel	l <sub>2</sub> ≈	l <sub>3</sub>	m <sub>1</sub>	m <sub>2</sub>	m <sub>3</sub>	m <sub>4</sub>	s	t	w Stroke
70	70	70	79 3.11	22 0.87	26 1.02	13 0.51	26 1.02	-	6 0.24	12 0.47	20 0.79
160	160	160	107 4.21	31 1.22	33.5 1.32	11.5 0.45	36.5 1.44	-	7 0.28	12 0.47	30 1.18
360	360	360	114 4.49	32 1.26	33.5 1.32	30 1.18	36.5 1.44	-	7 0.28	15 0.59	32 1.26
550	-	-	154.5 6.08	42 1.65	41 1.61	15 0.59	35 1.38	41 1.61	6 0.24	16 0.63	42 1.65
1100	-	-	170.5 6.71	49 1.93	41 1.61	15 0.59	35 1.38	41 1.61	8 0.31	18 0.71	50 1.97
2100	-	-	222 8.74	61 2.40	50 1.97	35 1.38	50 1.97	50 1.97	10 0.39	22 0.87	60 2.36
3100	-	-	300 11.81	100 3.94	54 2.13	40 1.57	70 2.76	70 2.76	10 0.39	25 0.98	100 3.94

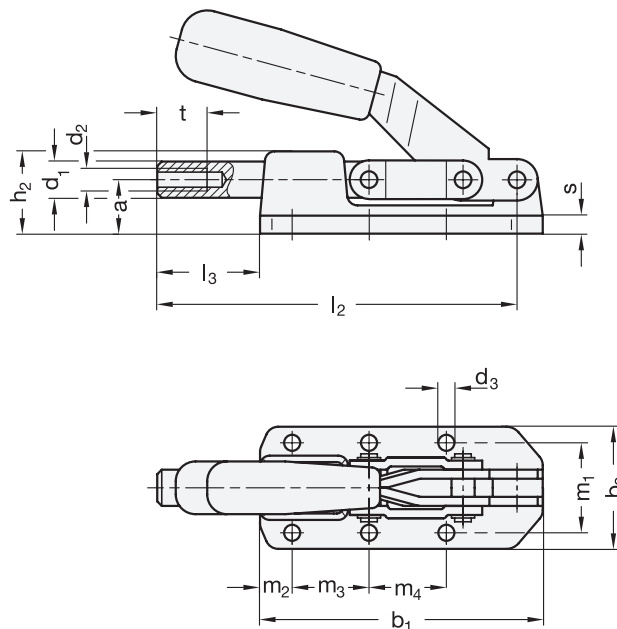

1.1  
1.2  
1.3  
1.4  
2.1  
2.2  
2.3  
2.4

