

Metric

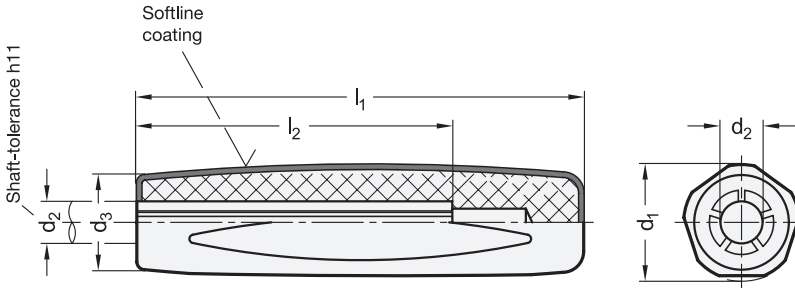

elesa
Original design EGH-SOFT



Metric table

Dimensions in: millimeters / inches

¹ d ₁	² d ₂ Bore	d ₃	l ₁	l ₂ min.
22 0.87	B 8	18 0.71	85 3.35	60 2.36

Specification

Base body

Plastic, Polypropylen (PP)

Softline coating

Elastomer (TPE) 70 Shore A

- Chemically bonded with base body
- FDA compliant plastic granulate
- Operating temperature 32 °F to 176 °F (0 °C to +80 °C)
- Black, matte finish

RoHS

Cylindrical handles EN 819 do not require a thread on the shaft.

During mounting, easy blows with a soft hammer are sufficient to drive the handle into place, the shaft end should be slightly rounded or chamfered (30°). The handle sits absolute vibration-tight.

The Softline coating makes them particularly ergonomic and easy to grip.

Technical Information

	Page
Product Family Ergostyle®	QVX
Product Family Softline	QVX
ISO Fundamental Tolerances	QVX
Plastic Characteristics	QVX

How to order

EN 819-22-B8

- 1 Handle diameter d₁
- 2 Bore d₂

1.1
1.2
1.3
1.4
2.1
2.2
2.3
2.4

