

Application example

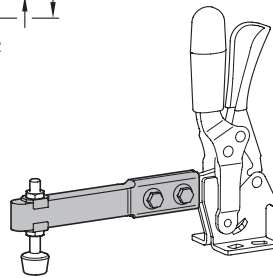

Metric table

Dimensions in: millimeters - inches

a	h ₁	b ₁	b ₂	d ₁	d ₂ Thread	h ₂	m	Length l	For toggle clamp size	
									GN 810 GN 810.1 GN 810.3 GN 810.4	GN 820 GN 820.1 GN 820.3 GN 820.4
67.5 2.66	16 0.63	10 0.39	21.5 0.85	6.3 0.25	M 5	21.5 0.85	20 0.79	121 4.76	130	130
71.5 2.81	18 0.71	12 0.47	26.5 1.04	8.2 0.32	M 6	24.5 0.96	26 1.02	142 5.59	230	230

Specification

- Steel, zinc plated, blue passivated finish **ST**
- RoHS compliant

Information

With GN 809.1 clamping arm extenders, various toggle clamps with a “solid bar” can be easily and quickly extended. The slot of the extender corresponds to the dimensions of the respective toggle clamp size with “U-bar clamping arm” and is therefore compatible with all accessories, such as flanged washers, spindle assemblies, etc.

For assembly, the clamping arm extenders are placed onto the clamping arms of the toggle clamps and bolted into place. The required holes in the clamping arm of the toggle clamp must be made by the user.

All parts are supplied in a non-assembled set. Two flanged washers are included for fastening the spindle assembly.

see also...

- Clamping Arm Extenders GN 801.1 (Rigid) → page 860
- Clamping Arm Extenders GN 801.2 (with Pivot Joint) → page 861
- Toggle Clamp Spindle Assemblies GN 804 → page 856
- Toggle Clamp Spindle Assemblies GN 807 → page 857

How to order	1 Length a
	2 Height h ₁
	3 Material
GN 809.1-71.5-18-ST	