

Electrical characteristics

Max. switching voltage / max. switching current	230 V AC, 230 V DC / 2 A
Max. switching capacity	40 W
Connector plug	DIN EN 175301-803 Type C
Protection class	IP 65
Cable gland	PG 7, for cable Ø from 6 to 7 mm
Cable cross-section	2 x 1.5 mm ²

Caution: Magnetic fields impair the function!

Assembly sequence for cable connection

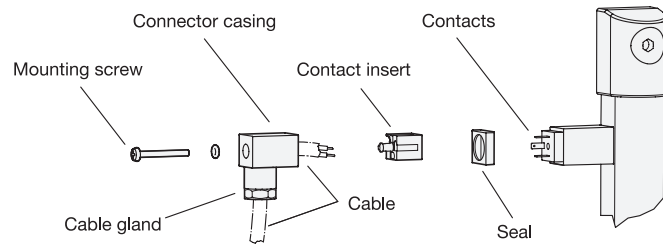

1. Loosen the mounting screw and pull off the connector plug.
2. Push the contact insert out of the connector casing.
3. Loosen the cable gland, guide the cable through the connector casing and connect it to the contact insert.
4. Push the contact insert back into the connector casing and tighten the cable gland for strain relief / sealing of the cable.
5. Push the connector plug over the contacts of the float switch and secure it with the mounting screw.

Assembly sequence for the assembly set on EN 654 / EN 654.1 fluid level indicators

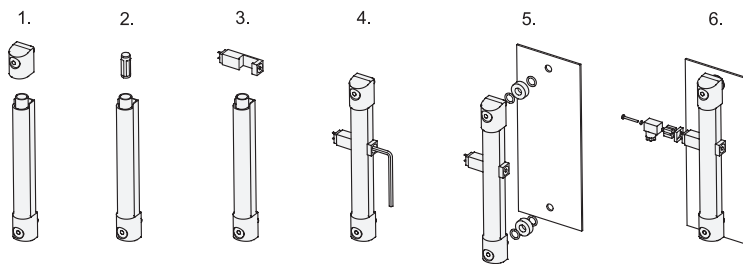

1. Take off the end piece of the fluid level indicator.
2. Insert and correctly position the float with the marking „UP“ pointing up.
3. Push on the switchgear unit.
4. Clamp the switchgear unit in the desired position and reassemble the end piece.
5. Mount the fluid level indicator in the container wall using both plastic spacer rings if the container is made of ferromagnetic material.
6. Mount the cable connection.

3-1
3-2
3-3
3-4
3-5
3-6
3-7
3-8
3-9
3-10

