

Identification no. 1

Identification no. 2

Metric

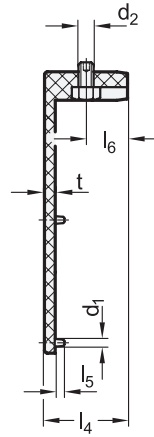
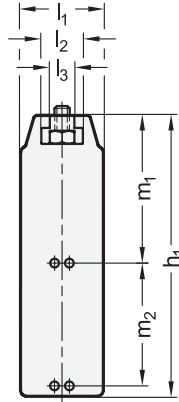
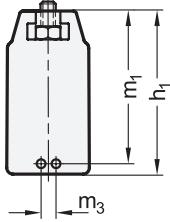

elesa
Original design TGL

Identification no.

- 1 Single row
- 2 Double row

Adjustable lever kit GN 511

Application example

Two-way mounting clamp GN 474

Side guide EN 6472

Connecting element EN 6473.2

Base plate mounting clamp GN 473

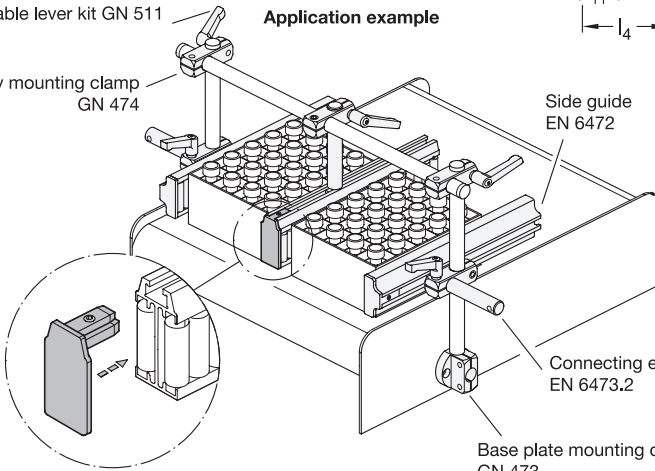

Metric table

Dimensions in: millimeters / inches

l ₁	d ₁	d ₂	h ₁		l ₂	l ₃	l ₄	l ₅	l ₆	m ₁	m ₂	m ₃	t
			ld. no. 1	ld. no. 2									
26	2.5	M 5	57.4	102.7	13.5	8	27	3	13.5	53.7	45.7	4.7	3.5
1.02	0.10		2.26	4.04	0.53	0.31	1.06	0.12	0.53	2.11	1.80	0.19	0.14

Specification

End cap

- Plastic, polyamide **PA**
- Operating temperature -22 °F to 212 °F (-30 °C to +100 °C)
- Gray **GR**

Set screw / nut

Stainless steel AISI 304

RoHS

Technical Information

- Plastic Characteristics QVX
- Stainless Steel Characteristics QVX

End caps EN 6472.2 extend side guides EN 6472. They ensure an attractive appearance and protect against injuries or damage to the conveyed goods. They are mounted on the end face by sliding into the T-slot of the side guide using the supplied set screw.

see also...

EN 6472 Side Guides

Page

QVX

How to order

1	Identification no.
2	Length l ₁
3	Material
4	Color

EN 6472.2-2-26-PA-GR

3.1
3.2
3.3
3.4
3.5
3.6
3.7
3.8
3.9
3.10