

Application example

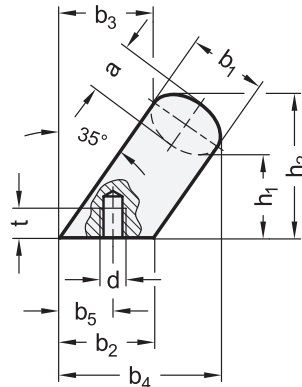
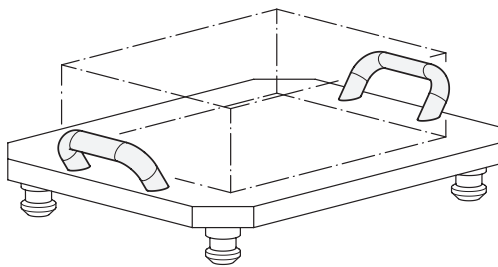

SS Stainless Steel

**3 Type**

**A** Mounting from the back (tapped blind hole)

**Metric table**

Dimensions in: millimeters - inches

| <b>b<sub>1</sub></b> | Length <b>l</b> ±0.25 | <b>a</b>   | <b>b<sub>2</sub></b> | <b>b<sub>3</sub></b> | <b>b<sub>4</sub></b> | <b>b<sub>5</sub> +1</b> | <b>d</b> | <b>h<sub>1</sub></b> | <b>h<sub>2</sub></b> | <b>r</b>   | <b>t</b><br>min. |
|----------------------|-----------------------|------------|----------------------|----------------------|----------------------|-------------------------|----------|----------------------|----------------------|------------|------------------|
| 20<br>0.79           | 112<br>4.41           | 13<br>0.51 | 24<br>0.94           | 32<br>1.26           | 50<br>1.97           | 13.5<br>0.53            | M 6      | 32<br>1.26           | 48<br>1.89           | 13<br>0.51 | 10<br>0.39       |
| 20<br>0.79           | 128<br>5.04           | 13<br>0.51 | 24<br>0.94           | 32<br>1.26           | 50<br>1.97           | 13.5<br>0.53            | M 6      | 32<br>1.26           | 48<br>1.89           | 13<br>0.51 | 10<br>0.39       |
| 26<br>1.02           | 128<br>5.04           | 17<br>0.67 | 32<br>1.26           | 34<br>1.34           | 57<br>2.24           | 18<br>0.71              | M 8      | 34<br>1.34           | 54<br>2.13           | 17<br>0.67 | 12<br>0.47       |
| 26<br>1.02           | 160<br>6.30           | 17<br>0.67 | 32<br>1.26           | 34<br>1.34           | 57<br>2.24           | 18<br>0.71              | M 8      | 34<br>1.34           | 54<br>2.13           | 17<br>0.67 | 12<br>0.47       |

**Specification**

- Stainless steel AISI 304  
Matte shot-blasted finish **MT**
- Load Rating Information → page 2068
- Stainless Steel Characteristics → page 2143
- RoHS compliant

**On request**

- Various metric size fasteners and kit packaging

**Information**

GN 565.7 angled cabinet U-handles are manufactured from a bent stainless steel profile and have excellent stability and ergonomic design.

The 35° angled contact surface allows improved access even in tight spaces such as corners.

see also...

- Cabinet U-Handles GN 425.1 (Steel / Stainless Steel / Aluminum, Offset) → page 144
- Cabinet U-Handles GN 426.6 (Stainless Steel, Offset) → page 151

How to order

**GN 565.7-20-128-A-MT**

- 1** Handle width **b<sub>1</sub>**
- 2** Length **l**
- 3** Type
- 4** Finish