

IF product design award

2 Type

- T1 With 1 button
- T2 With 2 buttons

3 Connection type

- K PUR cable
- S 5-pin connector (with 0.25 m cable)

Metric table

Dimensions in: millimeters - inches

l ₁ ±0.2	l ₂		l ₃	a	b	d Thread	h	t	Cable length l ₄ in meter	
	Type T1	Type T2							Connection type K	
117 4.61	158 6.22	181.5 7.15	105.5 4.15	10.2 0.40	33 1.30	M 6	44 1.73	12 0.47	2	5

Specification

- Body
Zinc die-cast **ZD**
Powder coated
Black, RAL 9005, textured finish **● SW**
Silver, RAL 9006, textured finish **● SR**
- Button
Stainless steel AISI 304
- Cable (outer sheath)
Polyurethan (PUR)
Black
- Light guide
Plastic
Crystal clear Polycarbonate (PC)
- IP Protection Classes → page 2130
- Plastic Characteristics → page 2135
- RoHS compliant

Information

Cabinet U-handles GN 422 come with one or two push buttons. Each button has a changeover contact and integrated LED ring lighting.
The button triggers an electrical control signal, such as for a machine control.
Independent whether or not the button is actuated, the integrated LED ring lighting shines either red or green depending on the polarity of connections 1 and 2 of the LED.
Complementary cabinet U-handles without switching function are available as GN 422.1.

see also...



- Cabinet U-Handles GN 422.1 (Aluminum) → page XYZ
- Bridge Handles EN 628.4 (Plastic, with Power Switching Function) → page 132
- Tubular Handles GN 331 (with Power Switching Function) → page 166

Accessory

- Cables with connector coupling GN 330 (5-pole, 5 oder 10 meters long) → page 1436

How to order (With 5-pin connector)	1 Material
GN 422-ZD-T2-S-SR	2 Type
	3 Connection type
	5 Finish

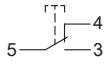
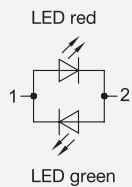
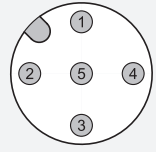
How to order (With PUR cable)	1 Material
GN 422-ZD-T1-K-5-SW	2 Type
	3 Connection type
	4 Cable length l ₄
	5 Finish

Electrical and mechanical characteristics		
Button Contacts Contact material Switching voltages Switching current Mechanical lifespan Electrical lifespan	Changeover contact, snap contact Silver alloy Max. 125 V (connector) Max. 240 V (cable) Max. 3A 10 ⁶ switching cycles 50,000 switching cycles (under full load)	
LED ring lighting Operating voltage / operating current - bi-color (red / green)	24 V DC ± 10 % / 7 mA	
Category of use (button)	AC 15: 24 V AC / 1 A / DC 13: 24 V DC / 0.7 A AC 15: 110 V AC / 1 A / DC 13: 110 V DC / 0.2 A AC 15: 220 V AC / 0.5 A / DC 13: 220 V DC / 0.1 A	according to IEC 60947-5-1
	AC: 120 V AC / 5 A / DC: 12 V DC / 1 A AC: 240 V AC / 3 A	according to UL 508
Connection type Cable (K) or Connector (S) Protection class	PUR cable with open stranded wires (2 m or 5 m) 5-pin connector M12x1 with PUR cable 0.25 m IP 67	Pin configuration and cable assignment  <ul style="list-style-type: none"> 1 - green 2 - white 3 - yellow 4 - gray 5 - brown
Approvals, conformity declarations CE marking		

Installation holes

The holes must be free of burrs to prevent damage to the cable.

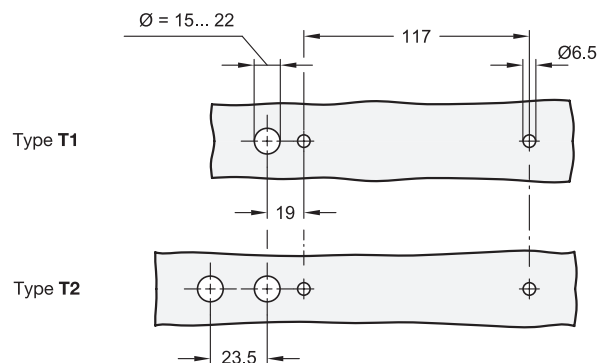

1.1
1.2
1.3
1.4
2.1
2.2
2.3
2.4

