

Metric

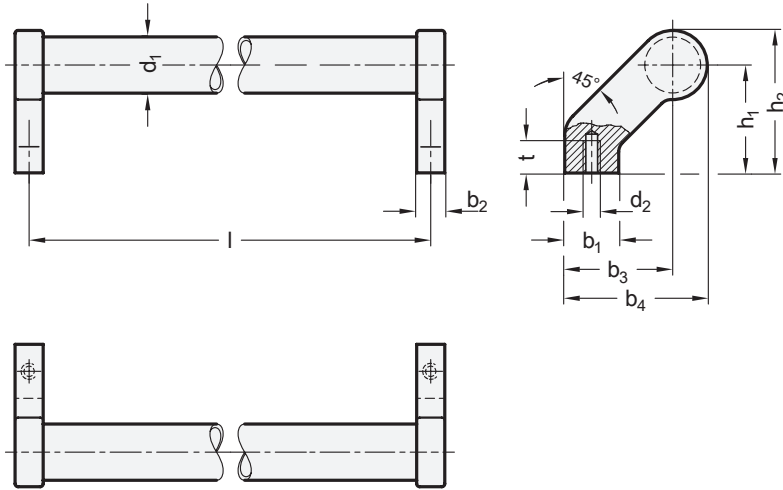

**SS** Stainless Steel

**Metric table**

1 2

Dimensions in: millimeters / inches

d <sub>1</sub>	Length l						b <sub>1</sub>	b <sub>2</sub>	b <sub>3</sub>	b <sub>4</sub>	d <sub>2</sub>	h <sub>1</sub>	h <sub>2</sub>	t min.
28 1.10	200 7.87	250 9.84	300 11.81	400 15.75	500 19.69	600 23.62	25 0.98	14 0.55	50 1.97	66 2.60	M 8	50 1.97	66 2.60	15 0.59

**Specification**

**Handle tube**

Stainless steel AISI 304, wall thickness 2 mm  
Ground, matte shiny finish

**Handle legs**

Stainless steel precision casting AISI CF-8  
Matte shot-blasted finish

RoHS

The tube of tubular handles GN 333.6 is pressed together with the handle legs.

Typical use is on double winged swinging doors and sliding doors on machines.

see also...

	Page
<b>GN 333.7</b> Tubular Handles (Straight Handle Legs)	QVX
<b>GN 426.5</b> Cabinet U-Handles	QVX
<b>GN 565.5</b> Cabinet U-Handles (Mounting from the Back or from the Operator's Side)	QVX
<b>GN 666.5</b> Tubular Grip Handles (Mounting from the Back)	QVX
<b>GN 333</b> Tubular Handles (Aluminium, Zinc Die-Cast)	QVX

**Technical Information**

Load Capacity Information	QVX
Stainless Steel Characteristics	QVX

**How to order**

**GN 333.6-28-250**

- 1 Handle diameter d<sub>1</sub>
- 2 Length l

1.1  
1.2  
1.3  
1.4  
2.1  
2.2  
2.3  
2.4

