

Identification no. 1

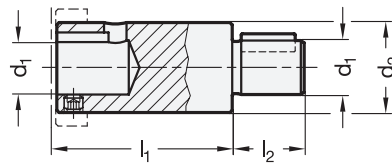

Identification no. 2

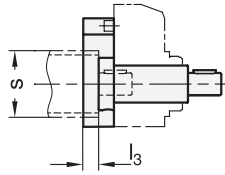
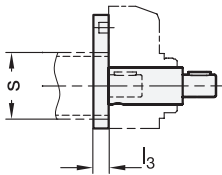

- 3 Identification no.**
- 1 For mechanical position indicators EN 953 / EN 954
  - 2 For electronic position indicators EN 9053 / EN 9054

**Metric table**

Dimensions in: millimeters - inches

<b>1</b> s ∅ Linear actuator	<b>2</b> d <sub>1</sub> f7	d <sub>2</sub>	b	h	Identification no.		l <sub>2</sub>	l <sub>3</sub>	For position indicator
					1	2			
30 1.18	8 0.31	14 0.55	40 1.57	43.5 1.71	35 1.38	42 1.65	15 0.59	12 0.47	EN 954 / EN 9054
40 1.57	12 0.47	20 0.79	50 1.97	56.5 2.22	39 1.54	49 1.93	16 0.63	12 0.47	EN 953 / EN 9053
50 1.97	12 0.47	20 0.79	60 2.36	61.5 2.42	39 1.54	49 1.93	17 0.67	12 0.47	EN 953 / EN 9053

**Specification**

- Adaptor shaft  
Steel, blackened finish
- Torque support  
Aluminum  
Plain, tumbled finish
- ISO Fundamental Tolerances → page 2129
- RoHS compliant

**Accessory**

- Position indicators and handwheels have to be ordered separately.

**Information**

GN 296 installation kits are required for mounting a position indicator on GN 291.1 square linear actuators. The kit consists of an adaptor shaft and a torque support including mounting screws.

When ordering EN 953 / EN 954 mechanical position indicators, a counter needs to be chosen that matches the pitch of the trapezoidal thread sprindle.

For EN 9053 / EN 9054 position indicators, the corresponding pitch is set on the position indicator by programming.

see also...

- Digital Position Indicators EN 953 → page 372
- Digital Position Indicators EN 954 → page 374
- Digital Position Indicators EN 9054 → page 380
- Digital Position Indicators EN 9053 → page 378
- Square Linear Actuators GN 291.1 → page 1952

How to order	<b>1</b> Linear actuator dimension s
<b>GN 296-30-8-1</b>	<b>2</b> Diameter d <sub>1</sub>
	<b>3</b> Identification no.

3.1  
3.2  
3.3  
3.4  
3.5  
3.6  
3.7  
3.8  
3.9  
3.10