

Bores for countersunk screw DIN 7991

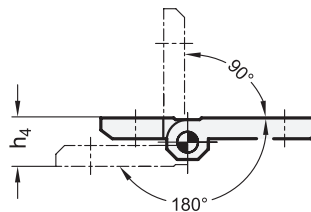

Swiveling range

Metric



elesa
ELESA original design CFM-L.

3 Type

A 2x2 bores for countersunk screws

Metric table

Dimensions in: millimeters - inches

1		2													
l_1		l_2	d_1	d_2	h_1	h_2	h_3	$h_4 \approx$	l_3	l_4	$m_1 \pm 0.25$	$m_2 \pm 0.25$	m_3	m_4	
Extended on one side	Extended on both sides														
63 2.48	-	50 1.97	6.5 0.26	6 0.24	11.5 0.45	6 0.24	6.5 0.26	13 0.51	18 0.71	31 1.22	43 1.693	30 1.181	15 0.59	28 1.10	
-	76 2.99	50 1.97	6.5 0.26	6 0.24	11.5 0.45	6 0.24	6.5 0.26	13 0.51	31 1.22	31 1.22	56 2.205	30 1.181	28 1.10	28 1.10	
90 3.54	-	60 2.36	6.5 0.26	8 0.31	15 0.59	8 0.31	8.5 0.33	17 0.67	21 0.83	51 2.01	63 2.480	36 1.417	18 0.71	45 1.77	
-	120 4.72	60 2.36	6.5 0.26	8 0.31	15 0.59	8 0.31	8.5 0.33	17 0.67	51 2.01	51 2.01	90 3.543	36 1.417	45 1.77	45 1.77	

Specification

- Body
Plastic
Technopolymer (Polyamide PA-HP)
- Glass fiber reinforced
- Temperature resistant up to 285 °F (140 °C)
- Black, matte finish
- Pin
Stainless steel AISI 303
- Load Rating Information → page QVX
- Plastic Characteristics → page QVX
- Stainless Steel Characteristics → page QVX
- RoHS compliant

Information

Hinges EN 237.1 with horizontally extended hinge leaves are made in a compact and sturdy design. They are used when larger spacings are required for the attachment bore holes.

see also...

- List of Hinge Types → page QVX
- Hinges EN 237.1 (Technopolymer Plastic) → page QVX
- Hinges GN 237 (Zinc Die-Cast, with Extended Hinge Wing) → page QVX
- Spacer Plates GN 2370 → page QVX
- Spacer Plates with Tapped Holes GN 2372 → page QVX
- Limit Stops GN 2374 → page QVX

How to order

EN 237.1-76-50-A

- 1** Length l_1
- 2** Width l_2
- 3** Type