

Assembly / profile machining



Metric



4 Type

A Without cover cap

Use

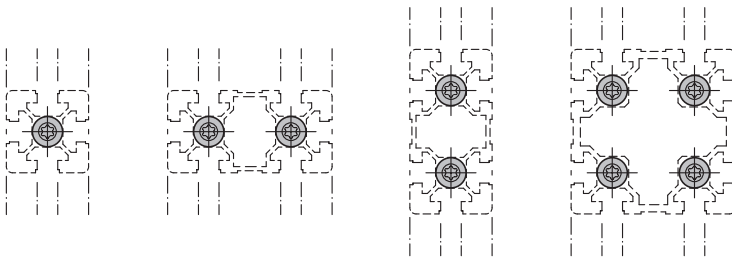

Metric table

Dimensions in: millimeters - inches

| 1 n | 2 d ₁ Self-forming thread | 3 l ₁ | d ₂ ≈ | d ₃ | l ₂ ≈ | A/F | Tightening torque in Nm |
|------------|--|-------------------------|------------------|----------------|------------------|-----|-------------------------|
| 8 0.31 | S 8 | 25 0.98 | 16 0.63 | 7.8 0.31 | 4.5 0.18 | T40 | 25 |
| 10 0.39 | S 12 | 30 1.18 | 19 0.75 | 9.8 0.39 | 6 0.24 | T50 | 35 |

Specification

- Steel, zinc plated, blue passivated finish **SZ**
- RoHS

Information

Central screws GN 21b connect aluminum profiles at right angles. Only one profile has to be machined. The thread in the end face profile hole is formed by the central screw itself. The self-forming thread should be lubricated to simplify assembly.

see also...

- Aluminum Profiles GN 10b (Profile Type Light) → page QVX
- Aluminum Profiles GN 10b (Profile Type Heavy) → page QVX

| | |
|---|--------------------------------|
| <p>How to order</p> <p>GN 21b-10 S12 30-A-SZ</p> | 1 Slot width n |
| | 2 Thread d ₁ |
| | 3 Length l ₁ |
| | 4 Type |
| | 5 Material / Finish |

Assembly Instructions / Profile Machining

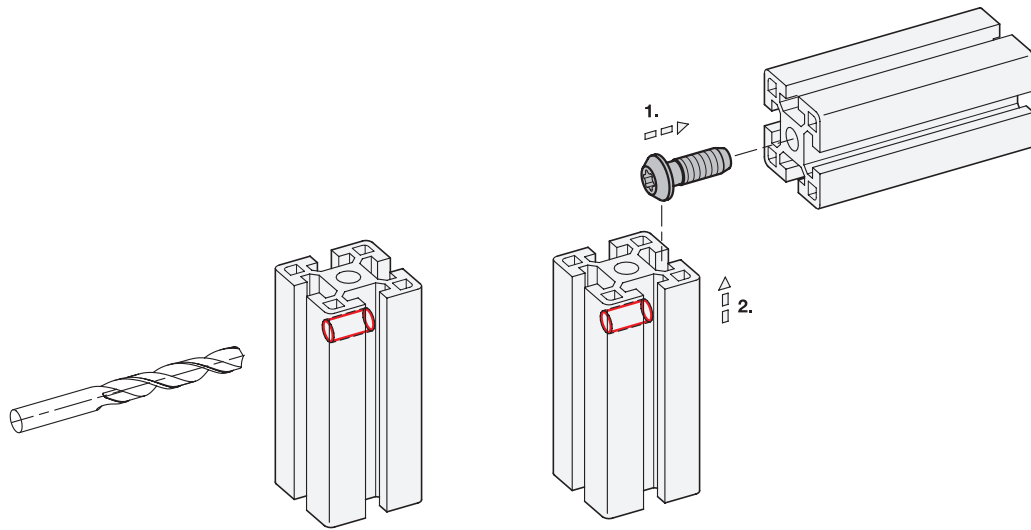

3.1

3.2

3.3

3.4

3.5

3.6

3.7

3.8

3.9

3.10

