

3 Type

- A** 2x2 tapped inserts
- B** 2x2 threaded studs
- C** 2x threaded studs (at the eccentric pin) / 2x tapped inserts
- D** 2x tapped inserts (at the eccentric pin) / 2x threaded studs

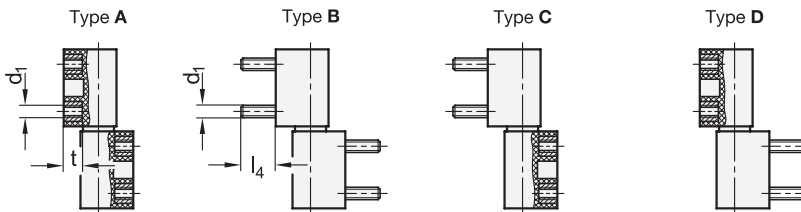

Metric table

Dimensions in: millimeters - inches

1	2	a	b	d₁	d₂	l₃	l₄	m	t
28	64	2	14.5	M 5	8	6	12	19	7.5
1.10	2.52	0.08	0.57		0.31	0.24	0.47	0.75	0.30

Specification

- Body
Plastic
Technopolymer (Polyamide PA)
- Glass fiber reinforced
- Black, matte finish
- Temperature resistant up to 176 °F (80 °C)
- Pin
Plastic
Technopolymer (Polyacetal POM)
- Tapped inserts
Brass, nickel plated
- Threaded studs
Steel, nickel plated
- Load Rating Information → page QVX
- Plastic Characteristics → page QVX
- RoHS compliant

Information

With EN 160 lift-off hinges, the two eccentric pins that form the fulcrum are offset 0.5 mm from each other. Because of this design, the position of the door can be altered or adjusted in relation to the door frame.

see also...

- List of Hinge Types → page QVX
- Lift-Off Hinges EN 160.1 → page QVX
- Lift-Off Hinges GN 161.1 → page QVX

How to order	1 Width l ₁
1 2 3 EN 160-28-64-B	2 Length l ₂
	3 Type

Construction and assembly instructions

The hinge section is to be attached to the door frame with the octagon holder.

First insert the pin such that the reference marking of the pin coincides with the arrow at the hinge.

The eccentric pin is to be placed in eight positions via the octagon.

Depending on position, l_1 changes: min. 27.5 / max. 28.5 mm.

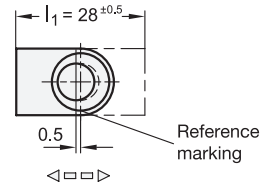
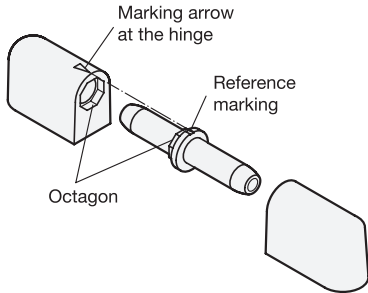

Aligning the door

To align the door, the eccentric pin of the top and bottom hinge may be turned into the required position.

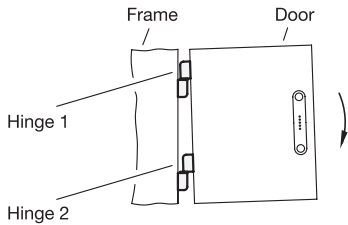

Hinge 1: Turn pin counter-clockwise

Hinge 2: Turn pin clockwise

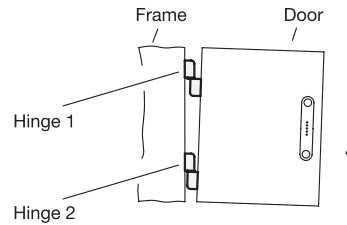

Hinge 1: Turn pin clockwise

Hinge 2: Turn pin counter-clockwise

Hinge layout

Door to be unhinged

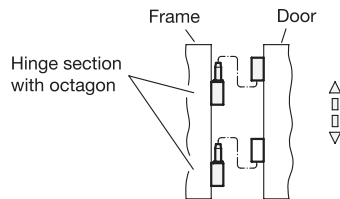

Door not to be unhinged

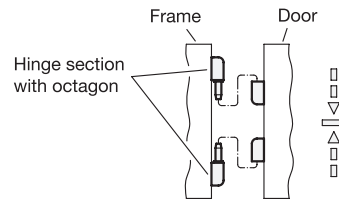

The top hinge section may be mounted to the frame only after the bottom hinge has been hung.