

# GN 14580.5 Socket Cap Screws

Steel / Stainless Steel, with Low-Profile Head, with Internal Hexalobular

Metric

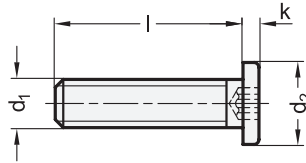
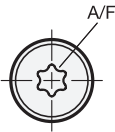

**SS** Stainless Steel

- 4** Identification no.
- 2** Head height k significantly reduced

## Metric table

**1** **2**

Dimensions in: millimeters / inches

d <sub>1</sub>	Length l												d <sub>2</sub>	k ±0.1	A/F	Max. tightening torque in Nm		
	Steel				Stainless steel											BN	NI	
M 2	-	-	-	-	4	5	6	8	10	12	-	-	-	4	0.5	T 4	-	0.15
	0.24	0.31	0.39	-	0.16	0.20	0.24	0.31	0.39	0.47	-	-	-	0.16	0.020	-	-	-
M 3	6	8	10	-	6	8	10	12	16	-	-	-	-	7	0.8	T 6	0.7	0.6
	0.24	0.31	0.39	-	0.24	0.31	0.39	0.47	0.63	-	-	-	-	0.28	0.031	-	-	-
M 4	6	8	10	-	6	8	10	12	16	20	25	-	-	8	0.9	T 8	2.3	1.5
	0.24	0.31	0.39	-	0.24	0.31	0.39	0.47	0.63	0.79	0.98	-	-	0.31	0.035	-	-	-
M 5	8	10	12	16	8	10	12	16	20	25	30	-	-	9	1	T10	4	3.1
	0.31	0.39	0.47	0.63	0.31	0.39	0.47	0.63	0.79	0.98	1.18	-	-	0.35	0.039	-	-	-
M 6	-	-	-	-	8	10	12	16	20	25	30	35	40	12	1.2	T20	-	5.3
	-	-	-	-	0.31	0.39	0.47	0.63	0.79	0.98	1.18	1.38	1.57	0.47	0.047	-	-	-

## Specification

**3**

<b>Steel</b>	<b>BN</b>
Chemically nickel plated, black	
<b>Stainless steel</b> AISI 304	<b>NI</b>
RoHS	

Socket cap screws GN 14580.5 are used to fasten parts where a counterbore is not possible and insufficient height is available for a normal screw head.

Due to their head geometry, screws according to this specification have a reduced load capacity as per ISO 898-1. The maximum tightening torque specified in the table may not be exceeded.

### see also...

Page

**GN 7984.2** Socket Cap Screws (with Low-Profile Head, with Recessed Stud for Loss Protection) QVX

**GN 7984.3** Socket Cap Screws (with Low-Profile Head and Reduced Head Diameter) QVX

### Technical Information

Stainless Steel Characteristics QVX

### How to order

<b>1</b> Thread d <sub>1</sub>
<b>2</b> Length l
<b>3</b> Material
<b>4</b> Identification no.

**GN 14580.5-M2-12-NI-2**

**1** **2** **3** **4**

3.1  
3.2  
3.3  
3.4  
3.5  
3.6  
3.7  
3.8  
3.9  
3.10