

3 Type

- R Clamping direction right turn
- L Clamping direction left turn

Metric table

Dimensions in: millimeters - inches

1 d ₁	2 Length l			d ₂	d ₃	d ₄	h ₁	h ₂
50 1.97	24 0.94	46 1.81	-	14 0.55	12 0.47	45 1.77	12 0.47	33 1.30
60 2.36	46 1.81	54 2.13	64 2.52	14 0.55	12 0.47	45 1.77	12 0.47	37 1.46
70 2.76	54 2.13	64 2.52	-	14 0.55	12 0.47	45 1.77	12 0.47	44 1.73

Specification

- Star knob EN 5337
Plastic
Duroplast (Phenolic PF)
- Black, shiny finish
- Temperature resistant up to 230 °F (110 °C)
- Bolt
Steel, zinc plated, blue passivated finish
- Latch arm
Steel, sintered
Pre-drilled hole for pinning
- Clamping pin for latch arm
Steel, blackened finish
3 x 20 mm DIN 1481
- *Plastic Characteristics* → page QVX
- **RoHS compliant**

On request

- Stainless steel version

Information

EN 118 door cam latches have a draw-in range of 2 mm. They are available in two types, where latching is achieved by turning the cam latch to the left (counter-clockwise), or it is achieved by turning the cam latch to the right (clockwise).

see also...

- *List of Cam Latch Types* → page QVX
- *Door Cam Latches GN 119* → page QVX
- *Door Cam Latches GN 117* → page QVX

<p>How to order</p> <p>1 2 3</p> <p>EN 118-50-46-R</p>	1 Handle diameter d ₁
	2 Length l
	3 Type



Construction and assembly instructions

Selecting the bolt length:

$$l \geq s + b + 15$$

Distance contact surface star knob – cross pin cam latch:

$$f = s + b + 8.5$$

s = Door thickness

b = Frame thickness

For easier installation, the cross hole to hold the clamping pin is already pre-drilled in the bolt. The clamping pin is included.

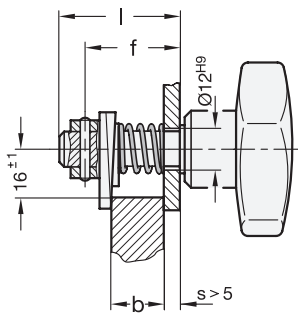

EN 118.1 Guide Bushing

For door thicknesses below 5 mm, the use of an EN 118.1 guide bushing is recommended.

A bushing, a hex nut and a serrated washer are supplied under this description. All parts are nickel plated or zinc plated.

For bolts with a length $l = 24$ mm, the EN 118.1 guide bushing is not suitable.

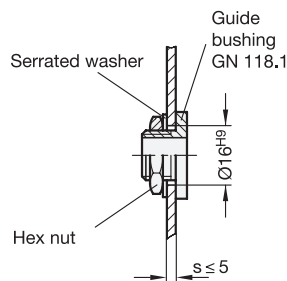

How to order

EN 118.1

