

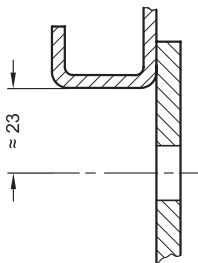

Hole distance

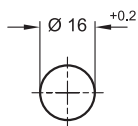

Mounting hole



Construction and assembly instructions

By turning the latch clockwise (right) the stepped cam latch moves up behind the door frame and pulls the door in.

The large pulling-in range of the cam (10 mm) allows these locks to be used successfully on doors with sealing strips. When selecting clamping range A the thickness of the seal might have to be taken into consideration.

For installation, two holes must be made in the door according to one of the two outline drawings.

The lock housing with the preassembled operating bolt is fitted into the hole from the front and held in position with the mounting nut on the back side. The distance piece and cam latch are then pushed one after the other onto the operating bolt from the back side and fastened with the hex head screw.

The required installation holes in the door leaf, are usually generated by drilling, punching or laser machining in series production. latch.

3.1
3.2
3.3
3.4
3.5
3.6
3.7
3.8
3.9
3.10

