

**1 Type**  
**SG** With star knob

**Metric table**

Dimensions in: millimeters - inches

**2**

Door width **T 1 - T 7**

T 1	T 2	T 3	T 4	T 5	T 6	T 7
1.5 - 3 0.06 - 0.12	3 - 4.5 0.12 - 0.18	4.5 - 6 0.18 - 0.24	6 - 7.5 0.24 - 0.30	7.5 - 9 0.30 - 0.35	9 - 10.5 0.35 - 0.41	10.5 - 12 0.41 - 0.47

**3**

Frame width **Z 1 - Z 15**

Z 1	Z 2	Z 3	Z 4	Z 5	Z 6	Z 7	Z 8	Z 9	Z 10	Z 11	Z 12	Z 13	Z 14	Z 15
0 - 9 0 - .35	3 - 12 .12 - .47	6 - 15 .24 - .60	9 - 18 .35 - .71	12 - 21 .47 - .83	15 - 24 .60 - .94	18 - 27 .71 - 1.06	21 - 30 .83 - 1.18	24 - 33 .94 - 1.30	27 - 36 1.06 - 1.42	30 - 39 1.18 - 1.54	33 - 42 1.30 - 1.65	36 - 45 1.42 - 1.77	39 - 48 1.54 - 1.89	42 - 51 1.65 - 2.00

Max. bolt length  $l_{max}$  for T + Z

T + Z	T + Z	T + Z	T + Z	T + Z	T + Z	T + Z	T + Z	T + Z	T + Z	T + Z	T + Z
≤ 13.5 ≤ 0.53	≤ 18 ≤ 0.71	≤ 22.5 ≤ 0.89	≤ 27 ≤ 1.06	≤ 31.5 ≤ 1.24	≤ 36 ≤ 1.42	≤ 40.5 ≤ 1.60	≤ 45 ≤ 1.77	≤ 49.5 ≤ 1.95	≤ 54 ≤ 2.13	≤ 58.5 ≤ 2.30	≤ 63 ≤ 2.48
31 1.22	35.5 1.40	40 1.57	44.5 1.75	49 1.93	53.5 2.11	58 2.28	62.5 2.46	67 2.64	71.5 2.81	76 3.00	80.5 3.17

**Specification**

- Star knob DIN 6336  
Plastic  
Technopolymer (Polyamide PA)  
Black, matte finish
- Latch arm  
Steel sheet metal, zinc plated,  
blue passivated finish
- Bolt and spacer  
Steel, zinc plated, blue passivated finish
- Other parts  
Steel, zinc plated, blue passivated finish  
or stainless steel
- Plastic Characteristics → page 2135
- RoHS compliant

**Information**

Door cam latches GN 117 lock by a turning operation clockwise (right), which moves the cam latch into the locked position behind the door frame. The latches are vibration proof and have a pulling-in range of 10 mm. Attention is drawn to its simple and hence cost saving installation.

The various operating bolts and distance pieces allow for a door thickness T1...T7 from 1.5 to 12 mm and a frame thickness Z1...Z15 from 0 to 51 mm.

see also...

- List of Cam Latch / Cam Lock Types → page 1256
- Door Cam Latches GN 119 → page 1292
- Compression Cam Latches GN 516 → page XYZ

How to order	<b>1</b> Type
<b>GN 117-SG-T2-Z5</b>	<b>2</b> Door width T
	<b>3</b> Frame width Z



Hole distance

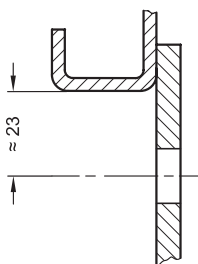

Mounting hole

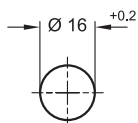

### Construction and assembly instructions

By turning the latch clockwise (right) the stepped cam latch moves up behind the door frame and pulls the door in.

The large pulling-in range of the cam (10 mm) allows these locks to be used successfully on doors with sealing strips. When selecting clamping range A the thickness of the seal might have to be taken into consideration.

For installation, two holes must be made in the door according to one of the two outline drawings.

The lock housing with the preassembled operating bolt is fitted into the hole from the front and held in position with the mounting nut on the back side. The distance piece and cam latch are then pushed one after the other onto the operating bolt from the back side and fastened with the hex head screw.

The required installation holes in the door leaf, are usually generated by drilling, punching or laser machining in series production. latch.

