

Metric

Application example

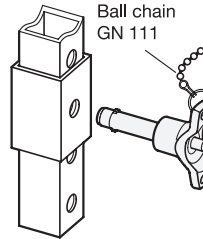

**SS** Stainless Steel

**Metric table**

		Dimensions in: millimeters / inches																									
<b>d<sub>1</sub></b>	<b>l<sub>1</sub> +0.4</b>																	<b>a</b>	<b>b</b>	<b>d<sub>2</sub></b>	<b>d<sub>3</sub></b>	<b>d<sub>4</sub></b>	<b>d<sub>5</sub></b>	<b>l<sub>2</sub></b>	<b>l<sub>3</sub></b>	<b>m</b>	
-0.1	Minimum size	10	12	16	20	25	30	35	40	45	50	60	70	80	90	100	110	120	3.3	1	11.7 +1	9.9	18	48	9.8	27.5	20
6	0.236	0.39	0.47	0.63	0.79	0.98	1.18	1.38	1.57	1.77	1.97	2.36	2.76	3.15	-	-	-	-	2.3	0.5	7.3 +0.5	5.9	15	40	7	22	15.5
8	0.315	0.39	0.63	0.79	0.98	1.18	1.38	1.57	1.77	1.97	2.36	2.76	3.15	3.54	3.94	-	-	-	2.8	0.6	9.8 +0.5	7.9	15	40	8.4	22	15.5
10	0.394	0.59	0.79	0.98	1.18	1.38	1.57	1.77	1.97	2.36	2.76	3.15	3.54	3.94	4.33	4.72	0.13	0.04	3.3	1	11.7 +1	9.9	18	48	9.8	27.5	20
12	0.472	0.79	0.98	1.18	1.38	1.57	1.77	1.97	2.36	2.76	3.15	3.54	3.94	4.33	4.72	5.12	0.15	0.04	3.8	1	13.7 +1	11.9	18	48	11.3	27.5	20
16	0.630	1.18	1.38	1.57	1.77	1.97	2.36	2.76	3.15	3.54	3.94	4.33	4.72	5.12	5.51	5.91	0.19	0.05	4.8	1.2	18.7 +1	15.9	22	58	14.2	34.5	27
20	0.787	1.18	1.38	1.57	1.77	1.97	2.36	2.76	3.15	3.54	3.94	4.33	4.72	5.12	5.51	5.91	0.19	0.05	4.8	1.2	22.7 +1	19.8	25	58	14.8	34.5	27

**Specification**

**Shank pin**

Stainless steel AISI 303

**Securing pawl**

Stainless steel sheet AISI 304

**T-handle**

Plastic, polyamide (PA)

- Black
- Operating temperature up to 176 °F (80 °C)

**Push button / Push rod**

Plastic, polyacetal (POM)

- Push button: Red
- Operating temperature up to 176 °F (80 °C)

**Bushing**

Stainless steel AISI 303

**Spring**

Stainless steel AISI 301

RoHS

**Accessory**

Accessory	Page
GN 111 Ball Chains	QVX
GN 111.2 Retaining Cables	QVX
GN 111.4 Spiral Retaining Cables	QVX

Rapid release pins GN 114.8 with axial lock are used to quickly fix, connect and secure various components. Typically, they are used as bearing bolts that have to be frequently assembled and disassembled.

The rectangular pawls made of stainless steel sheet metal hold the rapid release pin in an axial position in the bore. They are retracted with the push button and when released, the spring returns them to the locked position. The pawls are not aligned with the T-handle.

The technical section contains the load ratings for the double shear strength (breaking strength).

see also...

	Page
DIN 172 Press-Fit Drill Bushings (with Flange)	QVX
DIN 179 Press-Fit Drill Bushings (without Flange)	QVX

**Technical Information**

List of Lock Pin Types	QVX
Load Rating Information	QVX
Plastic Characteristics	QVX
Stainless Steel Characteristics	QVX

How to order

**GN 114.8-16-90**

1 Diameter d<sub>1</sub>

2 Length l<sub>1</sub>