

GN 111.7 | **Loss Protections (Recess with Lanyard Ring)**
for Various Standard Parts



GN 420 → page 696



GN 421 → page 697
GN 421.10 → www.jwwinco.com
GN 421.11 → www.jwwinco.com
GN 421.12 → www.jwwinco.com



SS Stainless Steel
DIN 464 → page 705
M6 ... M10



SS Stainless Steel
DIN 466 → page 704
M6 ... M12



EN 534 → page 680



EN 534 → page 682



SS Stainless Steel
EN 633 → page 663
EN 633.1 → page 664



SS Stainless Steel
EN 634 → page 660
EN 634.1 → page 660



SS Stainless Steel
GN 5334* → page 616
GN 5334.4 → page 616



SS Stainless Steel
GN 5334* → page 617
GN 5334.4 → page 617



EN 5337.2 → page 600
EN 5337.7 → page 604
Size 32 ... 63 mm



EN 5337.2 → page 602
EN 5337.7 → page 605
Size 32 ... 63 mm



EN 5337.4 → page 606



EN 5337.4 → page 608



DIN 6335 → page 626 /
page 630
KT / AL
Size 32 ... 63 mm



GN 6335.4 → page 634
GN 6335.5 → page 634
Type ST



DIN 6336** → page 572 / 576
KT / AL
Size 25 ... 63 mm



GN 6336.4** → page 580
GN 6336.5 → page 580
Type ST
Size 25 ... 63 mm



GN 6336.10 → page 582
GN 6336.11 → page 583
GN 6336.12 → page 583



SS Stainless Steel
GN 6336.3 → page 717

* see also GN 5334.13 (with Mounted Loss Protection) → page 618

** see also GN 6336.13 (with Mounted Loss Protection) → page 584



Specification

Recess for lanyard rings and GN 111.6 lanyard rings (stainless steel) according to standard sheet → page 1241

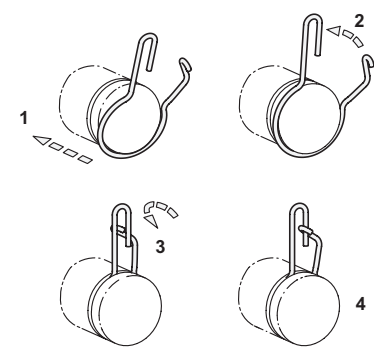

Information

The listed series can be supplied with a GN 111.7 loss protection by means of a recess and a lanyard ring.

The lanyard rings are supplied unassembled.

GN 111 / GN 111.5 ball chains and GN 111. 2 / GN 111.4 retaining cables are to be ordered separately.

see also...

- Star Knobs GN 6336.13 (with Mounted Loss Protection) → page 584
- Ball Chains GN 111 → page 1236
- Ball Chains GN 111.5 (Stainless Steel) → page 1236
- Retaining Cables GN 111.2 (Stainless Steel) → page 1238
- Spiral Retaining Cables GN 111.4 → page 1237

How to order

GN 111.7

Hollow knurled screws GN 421-M5-20
with loss protection **GN 111.7**

