

2 Type

- R** Jaw blocks at right angle to clamping arm
- P** Jaw blocks parallel to clamping arm

Mounting examples

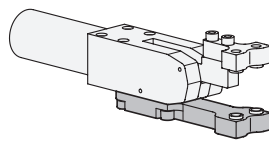

Type R

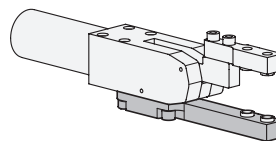

Type P

Metric table

Dimensions in: millimeters - inches

For pneumatic clamps Size	s -0.2	d ₁	d ₂ ^{H8/h6}	d ₃	d ₄ ^{H8/h6}	h	l ₁	l ₂	l ₃	l ₄	l ₅	l ₆	m ₁	m ₂	m ₃	m ₄
20 0.79	32 1.260	M 6	9 0.3543	M 5	7 0.2756	10 0.39	98.5 3.88	30 1.18	115.5 4.55	15 0.59	18.5 0.73	8 0.31	34 1.34	53 2.09	17 0.67	22 0.87
32 1.26	42 1.654	M 8	11 0.4331	M 6	9 0.3543	14 0.55	140 5.51	40 1.57	163 6.42	19 0.75	23.5 0.93	8.5 0.33	51 2.01	74.4 2.93	23 0.91	30 1.18
40 1.57	52 2.047	M 10	13 0.5118	M 8	11 0.4331	16 0.63	168 6.61	50 1.97	198 7.80	20 0.79	28 1.10	12.5 0.49	62 2.44	88.5 3.48	30 1.18	37 1.46
50 1.97	62 2.441	M 10	13 0.5118	M 10	13 0.5118	18 0.71	192.5 7.58	60 2.36	232.5 9.15	20 0.79	28 1.10	12.5 0.49	71.5 2.81	102 4.02	40 1.57	44 1.73

Specification

- Bracket
Steel C45
Chemically nickel plated **NC**
- Socket cap screws DIN 912,
centering guide bushings
Steel, blackened finish
- ISO-Fundamental Tolerances → page QVX
- RoHS compliant

Information

GN 869.2 straight / T-post gripper jaw block brackets have been designed for use with the clamping arms of GN 865 pneumatic fastening clamps.

The fastening clamp arms, gripper jaw block brackets and the GN 872 jaw blocks are precisely positioned when assembling all components together. GN 872 jaw blocks need to be ordered separately.

Socket cap screws and centering guide bushings are included.

see also...

- Jaw Blocks GN 872 → page QVX

How to order

GN 869.2-32-R-NC

- 1** Width s
- 2** Type
- 3** Finish