

- 2 Type**
- T3** With mounting holes, with U-bolt latch, with catch
  - T** With mounting holes, without U-bolt latch, with catch
  - T3S** Weldable, with U-bolt latch, with catch
  - TS** Weldable, without U-bolt latch, with catch

## Metric table

1

Dimensions in: millimeters - inches

Size	F <sub>H</sub> Holding capacity	a <sub>1</sub>	a <sub>2</sub>	b <sub>1</sub>	b <sub>2</sub>	b <sub>3</sub>	b <sub>4</sub>	b <sub>5</sub>	b <sub>6</sub>	b <sub>7</sub>	d <sub>1</sub>	d <sub>2</sub>	d <sub>3</sub>
1400	12000 N 2698 lbf	15 0.59	29 1.14	61 2.40	61 2.40	46 1.81	26 1.02	64 2.52	42 1.65	26 1.02	M 10	8.5 0.33	32.5 1.28

Size	h <sub>1</sub> ≈	h <sub>2</sub>	l <sub>1</sub> ≈	l <sub>2</sub> min.	m <sub>1</sub>	m <sub>2</sub>	m <sub>3</sub>	m <sub>4</sub>	m <sub>5</sub>	r ≈ at w <sub>2</sub> = 0	s	w <sub>1</sub> Stroke	w <sub>2</sub> ≈ Adjustable range
1400	64 2.52	24 0.94	171 6.73	42 1.65	38 1.50	14.5 0.57	32 1.26	12.5 0.49	17 0.67	109 4.29	8 0.31	50 1.97	22 0.87

## Specification

- Base / clamping lever  
Steel C22  
- Forged  
- Blackened finish
- Catch  
Steel sheet metal, blackened finish
- U-bolt latch / bearing pin  
Steel St 37  
Zinc plated, blue passivated finish
- All moving parts lubricated with special grease
- RoHS compliant

## Information

The U-bolt latch of GN 852.1 latch type toggle clamps is adjustable within the adjusting range. Once in the clamping position, the latch bolt is perpendicular to the clamping arm and to the mounting base of the toggle clamp. In addition to the standard lengths of the U-bolt latches shown in the table, a variety of other lengths are also available under the GN 951.2 series.

see also...

- *General Information on Toggle Clamps* → page 756
- *Square U-Bolts GN 951.2* → page 824

How to order

**GN 852.1-1400-T3**

1 Size

2 Type

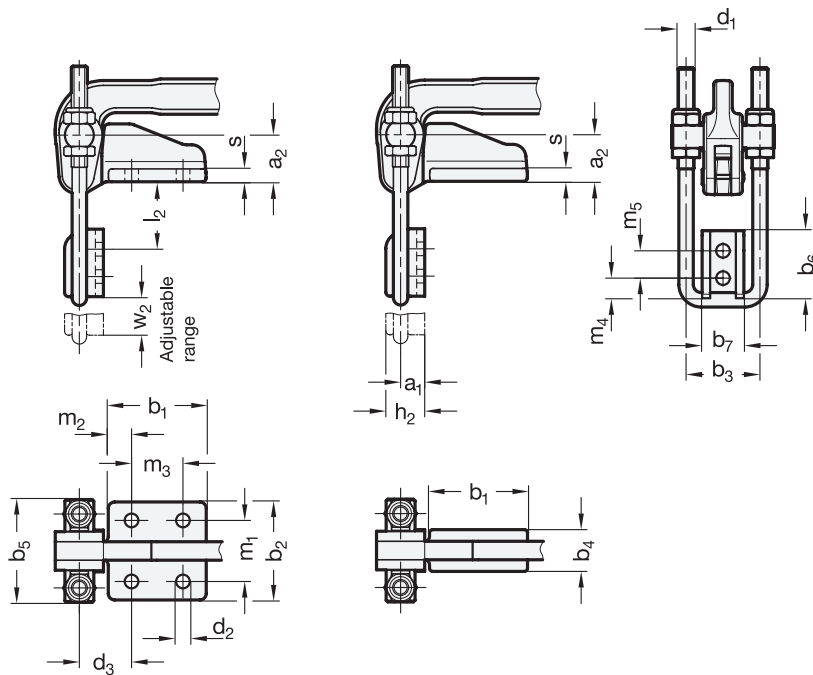

1.1  
1.2  
1.3  
1.4  
2.1  
2.2  
2.3  
2.4

