

Electrical properties of the sensor

Output function	Normally open (NO)	
Switch output	PNP	
Supply voltage	10 - 30 V DC	
Continuous current I_a	≤ 100 mA	
Connection type Plug (S)	3-pole plug M8x1, freely rotating with knurled screw connection, with PUR cable 0.5 m	
Protection class	IP 67	
Switching frequency	1,000 Hz	
Power consumption	≤ 8 mA	
Voltage drop	≤ 2.5 V	
Protection class	III	
Response sensitivity	2.8 mT	
Temperature range	-13 °F to +167 °F (-25 °C to +75 °C)	
Shock and vibration resistance	30 g, 11 ms / 10 - 55 Hz, 1 mm	
EMC	According to EN 60947-5-2	
Reverse polarity protection	Yes	
Short-circuit protection	Yes	
Activation impulse suppression	Yes	
Approvals, conformities CE declaration		CE

Assembly instruction

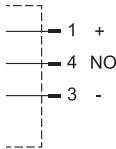
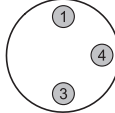
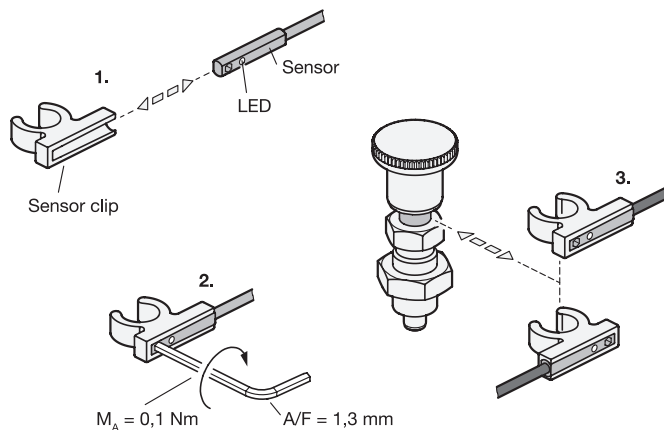

The position of the sensor cable can be freely determined when installing the sensor clip.

Installation steps:

1. Insert the sensor into the sensor clip from the side.
2. Tighten the hexagon socket screw of the sensor.
3. Clip the sensor clip into the ring slot of the indexing plunger in any orientation and then adjust the direction by turning, if necessary.