

GN 810.1

Steel / Stainless Steel

Vertical Acting Toggle Clamps

with Vertical Mounting Base



JW WINCO®
A Ganter Company

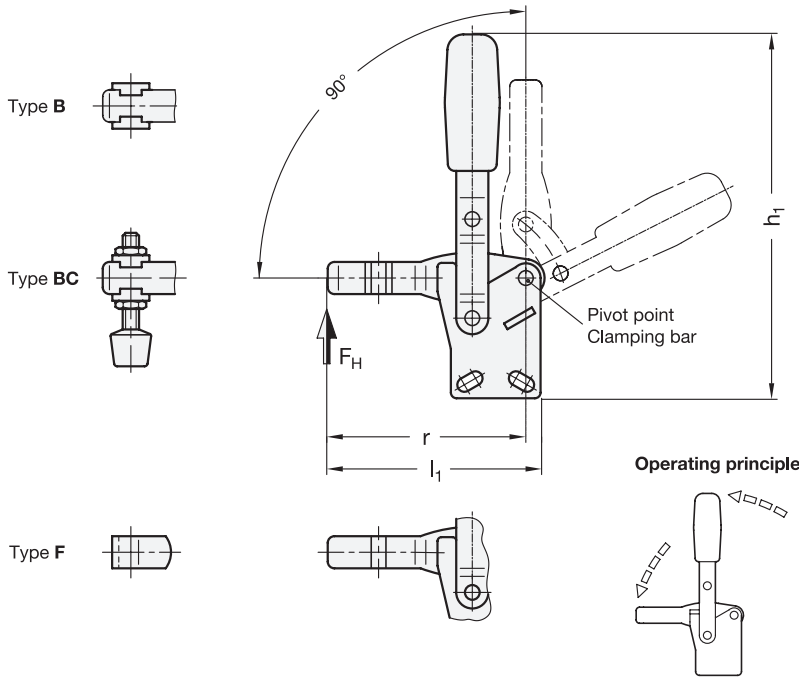

SS Stainless Steel

2 Type

- B** U-bar version, with two flanged washers
- BC** U-bar version, with two flanged washers and GN 708.1 spindle assembly
- F** Solid bar version, with weldable clasp

Specification

- Toggle clamp
Case-hardened steel C10 —
- Zinc plated, blue passivated finish
- Tempered bearing pins
- Case-hardened bearing rivets (for size 230 and up)
- Stainless steel AISI 304 **NI**
- All moving parts lubricated with special grease
- Hand grip
High quality, oil resistant red plastic
- Spindle assembly GN 708.1, Type A
- Steel, zinc plated, blue passivated finish / Stainless steel AISI 304
- Rubber tip 85 shore A
- RoHS compliant

Information

GN 810.1 vertical acting toggle clamps work according to the toggle principle: lever and clamping bar move in the same direction. In the clamped position the operating lever is in its vertical position.

Vertical acting toggle clamps in the U-bar version with two flanged washers (Type B) can accommodate an application specific clamping screw. A spindle assembly with neoprene rubber tip is also included for Type BC.

Type F version can either be utilized by welding the clasp which can then accommodate an application specific hold-down fastener component, or by utilizing the bar in conjunction with the GN 809 clamp mounts to hold the workpiece in place.

see also...

- *General Information on Toggle Clamps*
- *Heavy Duty Vertical Acting Toggle Clamps GN 910.1*
- *Vertical Acting Toggle Clamps GN 810 (with Horizontal Mounting Base)*

Accessory

- Spindle assemblies → starting on
- GN 801 clamp mounts (for Type B)
- GN 809 clamp mounts (for Type F)
- GN 801.1 clamping arm extenders (for Type B)
- GN 801.2 clamping arm extenders (for Type B)
- GN 809.1 clamping arm extenders (for Type F)

How to order (Steel)	1	Size
	2	Type
GN 810.1-430-B		

How to order (Stainless steel)	1	Size
	2	Type
	3	Material
GN 810.1-75-F-NI		

Universal table

Dimensions in: millimeters - inches

Size	Steel	Stainless steel	F _H Holding capacity	a ≈	b ₁	b ₂	b ₃	b ₄	d ₁ Thread	d ₂ ≈	h ₁ ≈	h ₂	h ₃	h ₄	h ₅ max.
75	75	75	750 N 169 lbf	20 .79	29 1.14	8 .31	4 .16	5.2 .20	M 5	4.5 .18	109 4.29	32 1.26	11 .43	19 .75	17 .67
130	130	130	1050 N 236 lbf	28 1.10	35 1.38	10 .39	5 .20	6.2 .24	M 6	5.5 .22	156 6.14	41.5 1.63	16 .63	25.5 1.00	25 .98
230	230	230	2000 N 450 lbf	40 1.57	43 1.69	12 .47	6 .24	8.5 .33	M 8	6.5 .26	183 7.20	48 1.89	18 .71	30 1.18	24 .94
330	-	-	2400 N 540 lbf	43 1.69	50 1.97	14 .55	7 .28	10.5 .41	M 10	8.5 .33	218 8.58	66 2.60	22 .87	37 1.46	39.5 1.56
430	-	-	2800 N 629 lbf	64 2.52	58 2.28	18 .71	10 .39	12.5 .49	M 12	8.5 .33	268 10.55	77.5 3.05	26 1.02	43 1.69	45 1.77
530	-	-	4500 N 1012 lbf	90 3.54	77 3.03	18 .71	10 .39	12.5 .49	M 12	12.5 .49	337 13.27	117.5 4.63	32 1.26	49 1.93	85 3.35

Size	Steel	Stainless steel	l ₁ ≈ Type B Type BC	Type F	l ₂ ≈	l ₃ max.	l ₄	m ₁	m ₂	m ₃	m ₄	r ≈	s	w Adjustable range
75	75	75	66.5 2.62	67 2.64	31.5 1.24	41 1.61	45 1.77	15 .59	16 .63	5 .20	5 .20	62.5 2.46	4 .16	15 .59
130	130	130	85 3.35	86 3.39	42 1.65	54 2.13	55 2.17	12.5 .49	19 .75	6.5 .26	7.5 .30	79 3.11	5 .20	17.5 .69
230	230	230	110.5 4.35	112 4.41	58 2.28	73 2.87	68 2.68	19 .75	20 .79	6.5 .26	6.5 .26	104 4.09	6 .24	20 .79
330	-	-	129 5.08	130.5 5.14	66 2.60	86 3.39	77 3.03	28.7 1.13	32.3 1.27	10 .39	9.5 .37	122 4.80	7 .28	19 .75
430	-	-	164 6.46	166 6.54	88 3.46	114 4.49	100 3.94	32 1.26	32 1.26	10 .39	10 .39	156 6.14	10 .39	33 1.30
530	-	-	223 8.78	225 8.86	128 5.04	155 6.10	100 3.94	50 1.97	51 2.01	12.5 .49	12.5 .49	212 8.35	10 .39	27 1.06

