

- 3 Type**
- A** Non lock-out, without lock nut
 - AK** Non lock-out, with lock nut
 - R** Lock-out, without lock nut
 - RK** Lock-out, with lock nut
 - S** With safety lock-out, without lock nut
 - SK** With safety lock-out, with lock nut

Plunger pin retracted

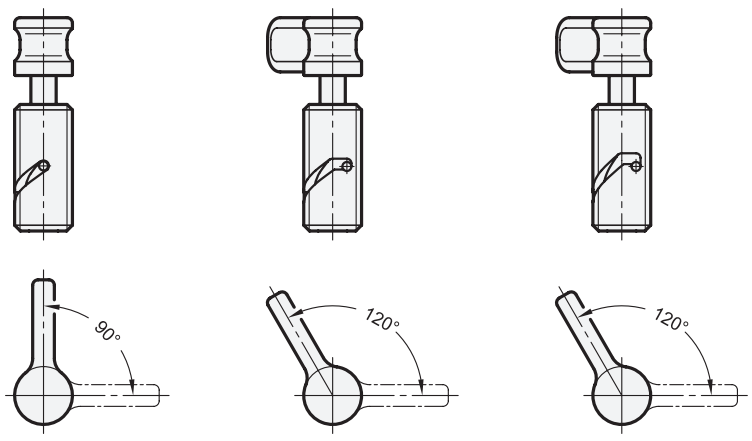

Metric table

Dimensions in: millimeters - inches

1 d₁ Pin h9 Bore G7	2 d₂ Thread	d₃	l₁ ≈	l₂	l₃ min.	l₄	Spring load ≈	
							Initial	End
6 <i>0.24</i>	M 16 x 1.5	16 <i>0.63</i>	51 <i>2.01</i>	8 <i>0.31</i>	35 <i>1.38</i>	32 <i>1.26</i>	6.5 N <i>1.46 lbf</i>	20 N <i>4.50 lbf</i>
8 <i>0.31</i>	M 16 x 1.5	16 <i>0.63</i>	51 <i>2.01</i>	8 <i>0.31</i>	35 <i>1.38</i>	32 <i>1.26</i>	6.5 N <i>1.46 lbf</i>	20 N <i>4.50 lbf</i>
10 <i>0.39</i>	M 16 x 1.5	16 <i>0.63</i>	51 <i>2.01</i>	8 <i>0.31</i>	35 <i>1.38</i>	32 <i>1.26</i>	6.5 N <i>1.46 lbf</i>	20 N <i>4.50 lbf</i>

Specification

- Threaded body
Steel, zinc plated, blue passivated finish
- Plunger pin
Stainless steel AISI 303
- Lever arm
Plastic
Technopolymer (Polyamide PA)
- Temperature resistant up to 230 °F (110 °C)
- Black, matte finish
- Not removable
- Lock nut
Steel, zinc plated
DIN 439 B / ISO 8675
- Load Rating Information → page 2103
- ISO Fundamental Tolerances → page 2129
- RoHS compliant

Information

GN 712 cam action indexing plungers are used in applications where the plunger pin must not protrude continually. When the lever arm is turned by 90 or 120 degrees in a counter-clockwise direction, the plunger pin is moved through a curved opening in the body. Then, the plunger pin is retracted.

Each version has its advantages as follows:

Type A / AK: After turning the lever arm counter-clockwise 90 degrees to retract the plunger pin, releasing the lever arm allows the plunger pin via the spring to protrude automatically.

Type R / RK: After turning the lever arm counter-clockwise 120 degrees to retract the plunger pin, there is a lock-out position for the guide pin that holds, via the spring, the retracted plunger pin in place. Turning the lever arm clockwise releases the plunger pin to its normal protruded position.

Type S / SK: After turning the lever arm counter-clockwise 120 degrees to retract the plunger pin, there is a secure lock-out position for the guide pin holding the retracted plunger pin, via the spring, in place. Pulling up, turning the lever arm clockwise and releasing the lever arm allows the plunger pin to protrude in its normal position.

see also...

- List of Cam Action Indexing Plungers Types → page 1001

On request

- Stainless steel version

How to order	1 Pin diameter d ₁
GN 712-8-M16x1.5-R	2 Thread d ₂
	3 Type