

Inch | Metric

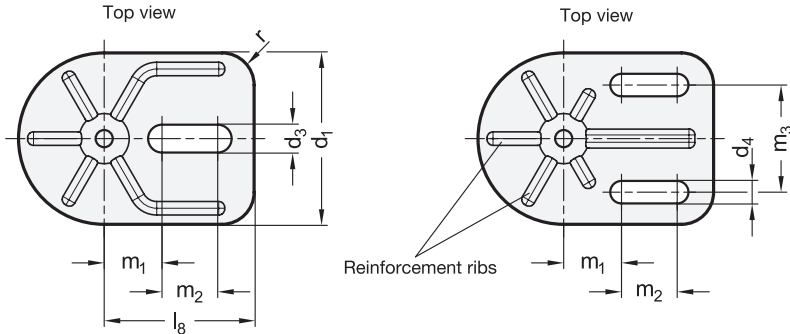

Type E0

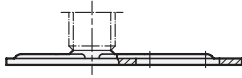

Type G0

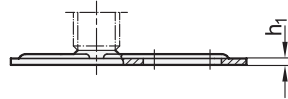

Type E3

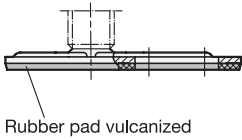

Type G3

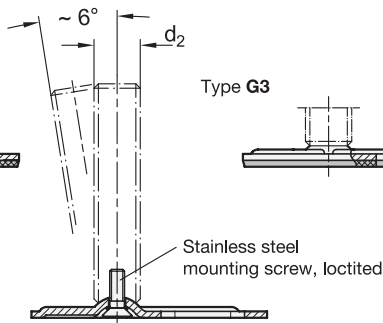
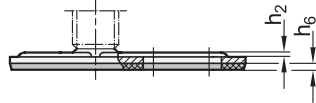

4 Type (Base)

- E0** Without rubber pad, with 1 slotted hole
- E3** With rubber pad, vulcanized, black, with 1 slotted hole
- G0** Without rubber pad, with 2 slotted holes
- G3** With rubber pad, vulcanized, black, with 2 slotted holes

Inch table

d ₁	d ₂ Thread	l ₁ Version S / SK				Version U / UK				l ₇ Version X	d ₃	d ₄	h ₁	h ₂	h ₆	l ₈	m ₁	m ₂	m ₃
		-	-	-	-	-	-	-	-										
3.15 80	5/16 x 18	-	-	-	-	-	-	-	-	1.02 26	0.51 13	0.41 10.5	0.12 3	0.05 1.3	0.12 3	2.76 70	1.06 27	1.02 26	1.97 50
3.15 80	3/8 x 16	2.95 75	3.94 100	4.92 125	5.91 150	-	-	-	-	1.14 29	0.51 13	0.41 10.5	0.12 3	0.05 1.3	0.12 3	2.76 70	1.06 27	1.02 26	1.97 50
3.15 80	1/2 x 13	2.95 75	3.94 100	4.92 125	5.91 150	-	-	-	-	1.26 32	0.51 13	0.41 10.5	0.12 3	0.05 1.3	0.12 3	2.76 70	1.06 27	1.02 26	1.97 50
3.15 80	5/8 x 11	-	-	-	-	2.95 75	3.94 100	4.92 125	5.91 150	1.50 38	0.51 13	0.41 10.5	0.12 3	0.05 1.3	0.12 3	2.76 70	1.06 27	1.02 26	1.97 50
3.15 80	3/4 x 10	-	-	-	-	3.94 100	4.92 125	5.91 150	-	1.77 45	0.51 13	0.41 10.5	0.12 3	0.05 1.3	0.12 3	2.76 70	1.06 27	1.02 26	1.97 50

Dimensions in: inches - millimeters

d ₁	d ₂ Thread	h ₃	h ₄	A/F ₁	A/F ₂	A/F ₃	A/F ₇	r	t
3.15 80	5/16 x 18	0.47 12	-	-	-	-	1/2	0.59 15	0.31 8
3.15 80	3/8 x 16	0.47 12	-	11/16	-	-	1/2	0.59 15	0.39 10
3.15 80	1/2 x 13	0.47 12	-	11/16	-	-	5/8	0.59 15	0.47 12
3.15 80	5/8 x 11	-	0.71 18	-	1/2	5/16	7/8	0.59 15	0.63 16
3.15 80	3/4 x 10	-	0.75 19	-	9/16	7/16	1	0.59 15	0.79 20

Stud / socket versions		
 S Without nut SK With nut	 U Without nut UK With nut	 X Tapped socket type
External hex at the bottom at d_2 3/8 x 16, 1/2 x 13 M 8, M 10, M 12	Internal hex at the top, wrench flat at the bottom at d_2 5/8 x 11, 3/4 x 10 M 16, M 20, M 24	External hex with tapped socket at d_2 5/16 x 18, 3/8 x 16, 1/2 x 13, 5/8 x 11, 3/4 x 10 M 8, M 10, M 12, M 16, M 20

Metric table

d ₁	d ₂ Thread	Version S / SK					Version U / UK					l ₇ Version X	d ₃	d ₄	h ₁	h ₂	h ₆	l ₈	m ₁	m ₂	m ₃
		40	50	63	-	-	75	100	125	150	200										
80 3.15	M 8	1.57	1.97	2.48	-	-	-	-	-	-	26	13	10.5	3	1.3	3	70	27	26	50	
80 3.15	M 10	1.97	2.36	3.15	3.94	-	-	-	-	-	29	13	10.5	3	1.3	3	70	27	26	50	
80 3.15	M 12	2.36	3.15	3.94	4.92	-	-	-	-	-	32	13	10.5	3	1.3	3	70	27	26	50	
80 3.15	M 16	-	-	-	-	2.95	3.94	4.92	5.91	7.87	9.84	1.50	0.51	0.41	0.12	0.05	0.12	2.76	1.06	1.02	1.97
80 3.15	M 20	-	-	-	-	2.95	3.94	4.92	5.91	7.87	9.84	1.77	0.51	0.41	0.12	0.05	0.12	2.76	1.06	1.02	1.97
80 3.15	M 24	-	-	-	-	3.94	4.92	5.91	7.87	11.81	-	-	0.51	0.41	0.12	0.05	0.12	2.76	1.06	1.02	1.97

d ₁	d ₂ Thread	h ₃	h ₄	A/F ₁	A/F ₂	A/F ₃	A/F ₇	r	t
80 3.15	M 8	12 0.47	-	17 0.67	-	-	14 0.55	15 0.59	8 0.31
80 3.15	M 10	12 0.47	-	17 0.67	-	-	14 0.55	15 0.59	10 0.39
80 3.15	M 12	12 0.47	-	17 0.67	-	-	17 0.67	15 0.59	12 0.47
80 3.15	M 16	-	18 0.71	-	12 0.47	8 0.31	22 0.87	15 0.59	16 0.63
80 3.15	M 20	-	19 0.75	-	15 0.59	10 0.39	27 1.06	15 0.59	20 0.79
80 3.15	M 24	-	22 0.87	-	19 0.75	12 0.47	-	15 0.59	-

Specification

- Base
Steel, zinc plated, blue passivated finish
- Threaded stud / tapped socket
Steel, zinc plated, blue passivated finish
- Inch size hex nut ANSI / ASME B18.2.2
Steel, zinc plated, blue passivated finish
- Metric size hex nut ISO 4032
Steel, zinc plated, blue passivated finish
- Rubber pad
NBR (Perbunan®) 70 ±5 shore A
- Vulcanized
- Black
- Load Rating Information → page 2120
- Elastomer Characteristics → page 2135
- RoHS compliant

Information

GN 42 leveling feet can be used universally thanks to the wide range of possible combinations of the base and the stud / socket versions. The leveling feet can be screwed to the mounting surface using the slotted mounting hole, which prevents lateral slippage. The types with rubber pad also protect sensitive surfaces. These leveling feet are supplied fully assembled and cannot be disassembled.

How to order (Inch)	1	2	3	4	5
GN 42-80-3/8X16-75-E0-S	Base diameter d ₁	Thread d ₂	Length l ₁ (Length l ₇)	Type (Base)	Stud / socket version

How to order (Metric)	1	2	3	4	5
GN 42-80-M20-45-G3-X	Base diameter d ₁	Thread d ₂	Length l ₇ (Length l ₁)	Type (Base)	Stud / socket version

3.1
3.2
3.3
3.4
3.5
3.6
3.7
3.8
3.9
3.10