

if product design award

2 Type

- T1 With 1 button
- T2 With 2 buttons

3 Connection type

- K PUR cable
- S 5-pin connector (with 0.25 m cable)

Metric table

Dimensions in: millimeters - inches

l ₁ ±0.2	l ₂		l ₃	a	b	d Thread	h	t	Cable length l ₄ in meter	
	Type T1	Type T2							Connection type K	Connection type S
117 4.61	158 6.22	181.5 7.15	105.5 4.15	10.2 0.40	33 1.30	M 6	44 1.73	12 0.47	2	5

Specification

- Zinc die-cast **ZD**
- Powder coated
- Black, RAL 9005, textured finish **● SW**
- Silver, RAL 9006, textured finish **● SR**
- Button
- Stainless steel AISI 304
- Cable (outer sheath)
- Polyurethan PUR, black
- Light guide
- Plastic
- Crystal clear Polycarbonate (PC)
- IP Protection Classes → page 2130
- Plastic Characteristics → page 2135
- RoHS compliant

Information

GN 422 cabinet “U” handles come with one or two push buttons. Each button has a changeover switch and integrated LED ring lighting.

When the button is pressed, an electrical control impulse to switch off a machine, for example, can be triggered based on the wiring of the contacts (NC or NO).

Independent of whether or not the button is actuated, the integrated LED ring lighting shines either red or green depending on the polarity of connections 1 and 2 of the LED.

The cabinet “U” handle is functional and highly compact and can be used for any application due to its universal design.

see also...



- Bridge Handles EN 628.4 (Plastic, with Power Switching Function) → page 132
- Tubular Handles GN 331 (with Power Switching Function) → page 166

Accessory

- Cables with connector coupling GN 330 → page 1436

How to order (With 5-pin connector)	1 Material
GN 422-ZD-T2-S-SR	2 Type
	3 Connection type
	5 Finish

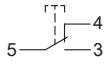
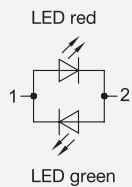
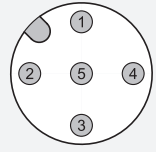
How to order (With PUR cable)	1 Material
GN 422-ZD-T1-K-5-SW	2 Type
	3 Connection type
	4 Cable length l ₄
	5 Finish

Electrical and mechanical characteristics		
Button Contacts Contact material Switching voltages Switching current Mechanical lifespan Electrical lifespan	Changeover contact, snap contact Silver alloy Max. 125 V (connector) Max. 240 V (cable) Max. 3A 10 ⁶ switching cycles 50,000 switching cycles (under full load)	
LED ring lighting Operating voltage / operating current - bi-color (red / green)	24 V DC ± 10 % / 7 mA	
Category of use (button)	AC 15: 24 V AC / 1 A / DC 13: 24 V DC / 0.7 A AC 15: 110 V AC / 1 A / DC 13: 110 V DC / 0.2 A AC 15: 220 V AC / 0.5 A / DC 13: 220 V DC / 0.1 A	according to IEC 60947-5-1
	AC: 120 V AC / 5 A / DC: 12 V DC / 1 A AC: 240 V AC / 3 A	according to UL 508
Connection type Cable (K) or Connector (S) Protection class	PUR cable with open stranded wires (2 m or 5 m) 5-pin connector M12x1 with PUR cable 0.25 m IP 67	Pin configuration and cable assignment  <ul style="list-style-type: none"> 1 - green 2 - white 3 - yellow 4 - gray 5 - brown
Approvals, conformity declarations CE marking		

Installation holes

The holes must be free of burrs to prevent damage to the cable.

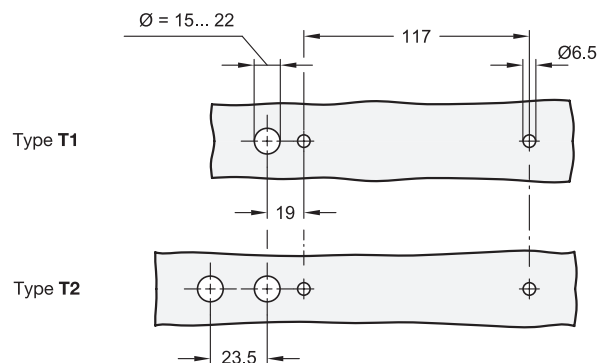

1.1
1.2
1.3
1.4
2.1
2.2
2.3
2.4

