

Resilient characteristics for rubber buffers GN 351 / GN 451 continued

GN 351 / GN 451

Type EE

Type ES

Type SS

Resilient characteristics for 70° Shore under axial and static load.

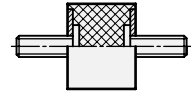
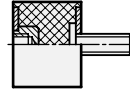

d ₁	h	Spring rate in N/mm ≈	max. load in N	max. travel in mm	Spring rate in N/mm ≈	max. load in N	max. travel in mm	Spring rate in N/mm ≈	max. load in N	max. travel in mm
8	8	75	150	2	75	150	2	75	150	2
8	13	47	150	3.25	45	145	3.25	41	130	3.25
10	10	83	165	2	80	200	2.5	80	200	2.5
10	15	40	150	3.75	40	150	3.75	40	56	1.4
10	20	20	100	5	19	96	5	18	88	5
15	10	290	580	2	290	715	2.5	290	715	2.5
15	15	135	515	3.75	140	515	3.75	140	515	3.75
15	20	94	470	5	94	470	5	94	470	5
15	25	-	-	-	81	505	6.25	80	500	6.25
20	15	365	550	1.5	280	1040	3.75	280	1040	3.75
20	20	200	955	5	200	955	5	200	955	5
20	25	160	1010	6.25	160	1010	6.25	160	1010	6.25
20	30	-	-	-	160	1210	7.5	130	980	7.5
25	15	-	-	-	715	2690	3.75	715	2690	3.75
25	20	305	1535	5	305	1530	5	305	1530	5
25	25	220	1370	6.25	-	-	-	-	-	-
25	30	160	1210	7.5	160	1210	7.5	160	1210	7.5
30	15	-	-	-	880	3300	3.75	880	3300	3.75
30	20	3230	2260	0.7	-	-	-	-	-	-
30	30	260	1960	7.5	260	490	2	260	490	2
30	40	200	2000	10	200	2000	10	200	2000	10
40	20	2820	6200	2.25	890	4450	5	890	4450	5
40	30	455	3420	7.5	455	3420	7.5	455	3420	7.5
40	40	320	3190	10	320	3190	10	320	3190	10
50	20	-	-	-	1850	9240	5	1850	9240	5
50	30	725	5450	7.5	725	5450	7.5	725	5450	7.5
50	40	495	4940	10	495	4940	10	495	4940	10
50	50	420	4750	11.25	380	4750	12.5	380	4750	12.5
60	30	1220	9130	7.5	1215	9130	7.5	1215	9130	7.5
60	40	695	6950	10	695	6950	10	695	6950	10
60	50	715	7125	10	525	6570	12.5	525	6570	12.5
70	30	2420	7250	3	3380	24010	7	3380	24010	7
70	45	1170	13210	11.25	1170	13210	11.25	1170	13210	11.25
75	25	-	-	-	4000	25000	6.25	4000	25000	6.25
75	30	5000	25000	5	-	-	-	-	-	-
75	40	1540	15380	10	1540	15380	10	1540	15380	10
75	55	817	11240	13.75	815	11240	13.75	815	11240	13.75
100	40	2900	29000	10	2900	29000	10	2900	29000	10
100	55	1760	24260	13.75	1760	24260	13.75	1760	24260	13.75
100	75	1190	22350	18.75	1190	22350	18.75	1190	22350	18.75
125	55	3185	25000	7.85	3010	23610	7.85	3010	23610	7.75
125	75	1270	23750	18.75	1290	24200	18.75	1160	21790	18.75

