

Details hub with coupling attachments

with bearing bushing: Identification no. 1

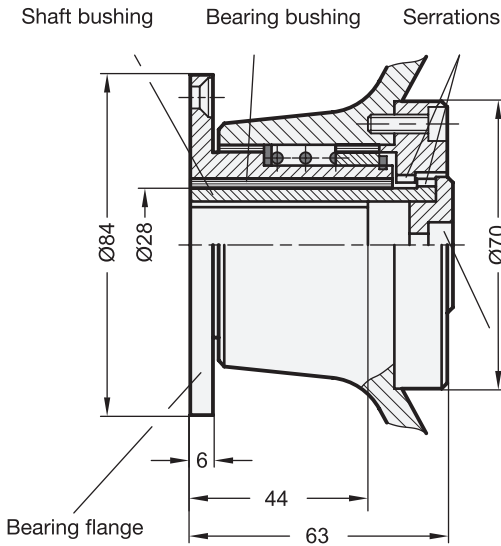

with centring ring: Identification no. 2

3 bores for countersunk screws DIN 7991-M5

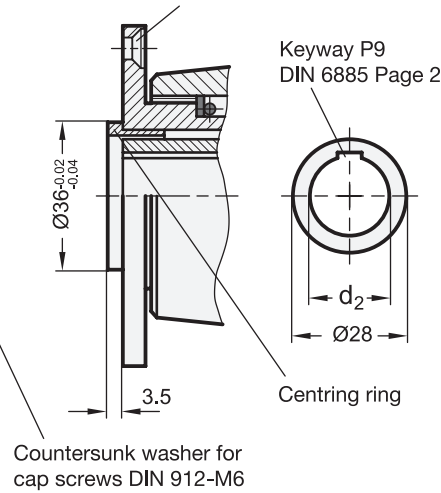

Specification of shaft and dimensions

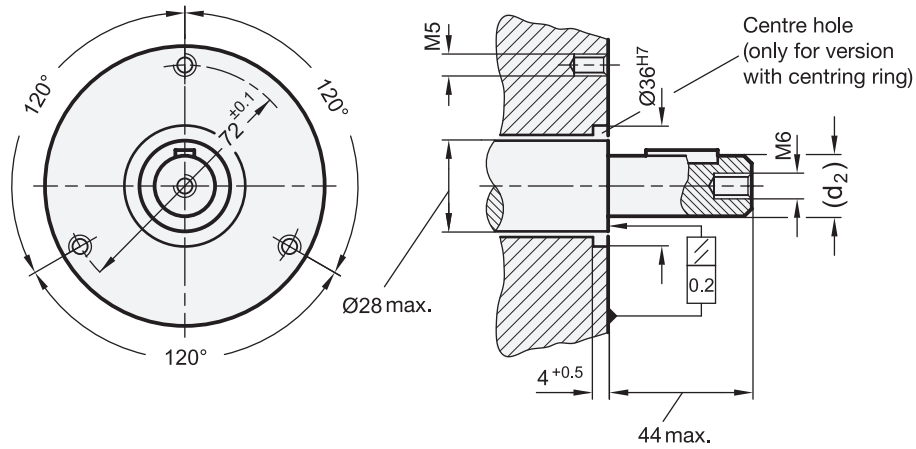

Assembly instructions

Shaft bushing and countersunk washer are delivered in two separate components. Before assembly, make sure that the shaft bushing can be pushed smoothly and free-moving over the shaft.

Proper function is guaranteed only if:

- shaft bushing and bearing surface are level with each other
- the shaft axis lies at a right angle to the bearing surface on the machine side.

Design with bearing bushing (identification no. 1)

Push the handwheel and the shaft bushing over the shaft at the same time, bolt down the bearing flange, and fix the shaft bushing axially with the countersunk washer.

Design with centering ring (identification no. 2)

The handwheel can be bolted through the centering ring immediately above the bearing flange. Then push the shaft bushing onto the shaft and fix it axially with the countersunk washer.