

Pin Ø 6 / 8
Ball retainer one-sided

Pin Ø 10 / 12
Ball retainer both-sided

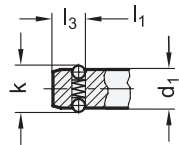

Application example

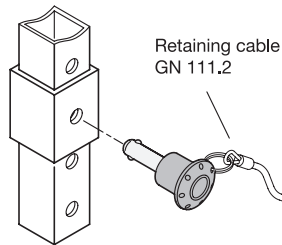

SS Stainless Steel

Metric table

Dimensions in: millimeters - inches

d₁ <small>-0.04 -0.08</small>	l₁						d₂	d₃	k	l₂	l₃	Location bore	Axial holding force ≈
6 <i>0.24</i>	10 <i>0.39</i>	15 <i>0.59</i>	20 <i>0.79</i>	25 <i>0.98</i>	30 <i>1.18</i>	50 <i>1.97</i>	26 <i>1.02</i>	17.5 <i>0.69</i>	6.5 <i>0.26</i>	22 <i>0.87</i>	5 <i>0.20</i>	6 <i>0.24</i>	8 N <i>1.80 lbf</i>
8 <i>0.31</i>	15 <i>0.59</i>	20 <i>0.79</i>	25 <i>0.98</i>	30 <i>1.18</i>	50 <i>1.97</i>	-	26 <i>1.02</i>	17.5 <i>0.69</i>	8.7 <i>0.34</i>	22 <i>0.87</i>	6.3 <i>0.25</i>	8 <i>0.31</i>	15 N <i>3.37 lbf</i>
10 <i>0.39</i>	15 <i>0.59</i>	20 <i>0.79</i>	25 <i>0.98</i>	30 <i>1.18</i>	50 <i>1.97</i>	-	34 <i>1.34</i>	23 <i>0.91</i>	12 <i>0.47</i>	28.5 <i>1.12</i>	8.7 <i>0.34</i>	10 <i>0.39</i>	30 N <i>6.74 lbf</i>
12 <i>0.47</i>	20 <i>0.79</i>	30 <i>1.18</i>	40 <i>1.57</i>	50 <i>1.97</i>	-	-	34 <i>1.34</i>	23 <i>0.91</i>	14.5 <i>0.57</i>	28.5 <i>1.12</i>	9.5 <i>0.37</i>	12 <i>0.47</i>	32 N <i>7.19 lbf</i>

Specification

- Shank pin
Stainless steel AISI 303
- Knob
Plastic (Polyamide PA)
- Black-gray
- Temperature resistant up to 176 °F (80 °C)
- Balls
Stainless steel AISI 420C
- Spring
Stainless steel AISI 631
- Load Rating Information → page 2104
- Plastic Characteristics → page 2135
- Stainless Steel Characteristics → page 2143
- RoHS compliant

Accessory

- Ball chains GN 111 / GN 111.5 → page 1236
- Retaining cables GN 111.2 → page 1238
- Spiral retaining cables GN 111.4 → page 1237

Information

GN 124.2 quick release pins are used for rapid connecting and securing of components or workpieces. The retaining balls are held in position by a compression spring, are not rigidly locked and therefore, the quick release pin can be quickly and easily inserted and removed from the location bore. The technical section contains the load ratings for the double shear strength (breaking strength).

see also...

- List of Lock Pin Types → page 1058
- Rapid Release Pins GN 214.3 → page www.jwwinco.com
- Rapid Release Pins GN 114.3 → page 1071
- Press-Fit Drill Bushings DIN 172 (Cylindrical, with Flange) → page 1172
- Press-Fit Drill Bushings DIN 179 (Cylindrical, without Flange) → page 1172

How to order GN 124.2-6-10	1 Pin diameter d₁
	2 Length l₁