

Construction and assembly instructions

Depending on the installation application, the 90° rotary movement range of the latch arm can be defined by means of a plug-type element that can be mounted in 4 different positions.

This allows the cam latch with cabinet “U” handle to be used in any attachment position regardless of the turning and latching direction or of the narrow side of the door. Subsequent repositioning of the 90° rotary range is possible.

The drawing below shows the latch arm placement options and the resulting 90° rotary ranges.

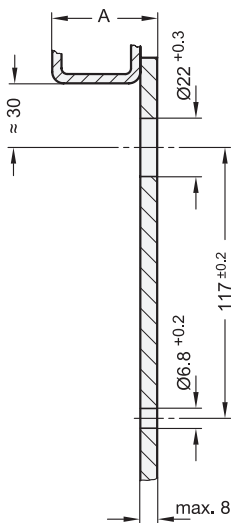
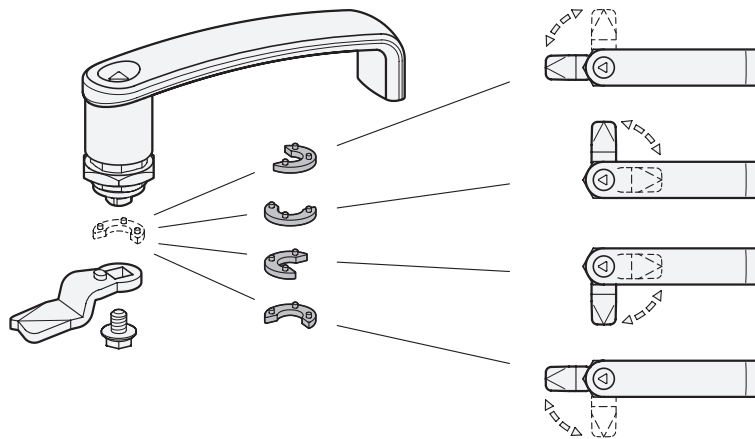

For mounting, the door should have two bore holes as shown in the drawing, attached at a distance of 30 mm from the door frame.

If preassembled (cabinet “U” handle and latch arm), the cam latch housing can be inserted in the door through the bore hole from the front. From the inside, screw the M6 assembly screw, positioning piece and latch arm in its proper position together, then place the hex jam nut over the latch arm and assemble the unit to the door.

The latch housing threaded body (M22 x 1.5) has 4 surfaces, allowing the cabinet “U” handle to be used also with the standard bore holes of GN 115 cam latches. → page 1260