

- 1 Type**
- DK** With triangular spindle
  - VK7** With square spindle
  - VK8** With square spindle
  - SCH** With slot
  - VDE** With double bit

**Metric table**

**2** Dimensions in: millimeters - inches

Latch distance <b>A</b>																					
4	6	8	10	13	14	16	18	20	22	24	26	28	30	32	34	36	38	40	42	45	50
0.16	0.24	0.31	0.39	0.51	0.55	0.63	0.71	0.79	0.87	0.94	1.02	1.10	1.18	1.26	1.34	1.42	1.50	1.57	1.65	1.77	1.97

**Specification**

- Cabinet "U" handle  
Zinc die-cast, powder coated  
Black, RAL 9005, textured finish **● SW**  
Silver, RAL 9006, textured finish **● SR**
- Latch arm / assembly hardware  
Steel, zinc plated, blue passivated finish
- RoHS compliant

**Accessory**

- Socket keys GN 119.2 → page 1310

**Information**

GN 115.7 cam latches are used when the application requires both a latching mechanism and a handle. They close via a turning operation limited to 90° (quarter of a turn) of the three-edged wedge in type DK, which moves the latch arm behind the door frame. The beveled edges of the latch arm create a smooth latching of the door.

The 22 different off-set latch arm options allow for "Latch distance A" to be set between 4 mm and 50 mm.

Product comes supplied with a loosely enclosed latch arm.

The socket key latches the latch arm and provides security from accidentally opening but does not lock the arm in place.

A socket key is not included.

see also...

- List of Cam Latch / Cam Lock Types → page 1256
- Door Cam Latches GN 119.3 (with Cabinet "U" Handle) → page 1296
- Cam Latches GN 115.10 (with Gripping Tray) → page 1276

<b>How to order</b>	<b>1 Type</b>
<b>GN 115.7-SCH-20-SR</b>	<b>2 Latch distance A</b>
	<b>3 Color</b>

**Construction and assembly instructions**

Depending on the installation application, the 90° rotary movement range of the latch arm can be defined by means of a plug-type element that can be mounted in 4 different positions.

This allows the cam latch with cabinet “U” handle to be used in any attachment position regardless of the turning and latching direction or of the narrow side of the door. Subsequent repositioning of the 90° rotary range is possible.

The drawing below shows the latch arm placement options and the resulting 90° rotary ranges.

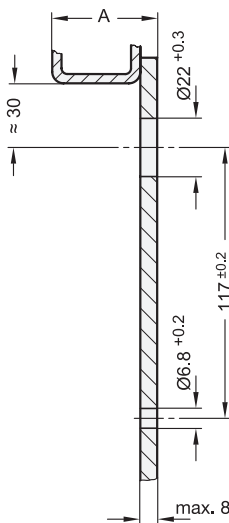
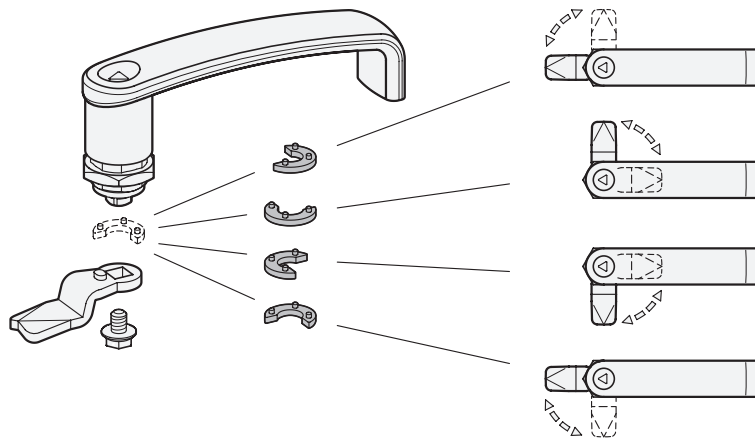

For mounting, the door should have two bore holes as shown in the drawing, attached at a distance of 30 mm from the door frame.

If preassembled (cabinet “U” handle and latch arm), the cam latch housing can be inserted in the door through the bore hole from the front. From the inside, screw the M6 assembly screw, positioning piece and latch arm in its proper position together, then place the hex jam nut over the latch arm and assemble the unit to the door.

The latch housing threaded body (M22 x 1.5) has 4 surfaces, allowing the cabinet “U” handle to be used also with the standard bore holes of GN 115 cam latches. → page 1260

